

WORLD CLASS TRACTION & HYDRAULIC ELEVATORS



ENVIRONMENTAL-FRIENDLY
INNOVATIONS & MODERNIZATIONS



KINETIC

Lift for life time

COMPANY PROFILE

KINETIC ELEVATORS LTD., INDIA
BASED LIFT-MAKERS WITH MAIN OFFICE
& WORKS IN AHMEDABAD GUJARAT
STATE. OUR ANNUAL CAPACITY ARE 550
LIFTS. OUR COMPANY WAS FOUNDED IN
1986 AT AHMEDABAD IN WESTERN INDIA.
WE ARE SPECIALIZED IN TRACTION LIFTS
WITH A SPEED UPTO 2.50 M/S AND
CAPACITY RANGES UPTO 10,000 KGS.
MORE THAN 7000 LIFTS CAN BE FOUND
SERVING PEOPLE SAFELY AND
DEPENDABLY IN ALL TYPES OF PUBLIC
AND PRIVATE BUILDINGS ALL OVER
INDIA, NEPAL & BHUTAN.

WE OFFER DESIGN, PRODUCTION,
ASSEMBLY, NEW LIFT INSTALLATION,
DISTRIBUTION, MAINTENANCE,
REPLACEMENT PARTS, MODERNIZATION
PROGRAMS, REPAIR, CONSULTATION FOR
PASSENGER LIFTS, HOSPITAL LIFTS,
GOOD LIFTS, SERVICE LIFTS, ESCALATORS.

WE HAVE AN EXTENSIVE LINE OF
STANDARD PRODUCTS, SPECIALIZATION
IN CUSTOM DESIGNED LIFTS TO SUIT
UNIQUE STRUCTURAL OR AESTHETIC
REQUIREMENTS.

WE OFFER FULL CONSULTANCY SERVICES
FOR PROPOSED NEW PROJECTS,
ADVISING DETAILS OF THE NUMBER,
TYPE, SPEED AND DUTY OF LIFTS,
ESCALATORS AND WALKWAYS MOST
SUITED TO THE BUILDING
REQUIREMENTS. THIS IS PARTICULARLY
BENEFICIAL IN "DESIGN AND
CONSTRUCTION" SITUATIONS. BY PAYING
ATTENTION TO DETAILS OF THE ENTIRE
CONCEPT OF A BUILDING AND BY
POSSESSING AN IN DEPTH
UNDERSTANDING OF HOW LIFT SYSTEMS

OPERATE, OUR EXPERIENCED
AND QUALIFIED ENGINEERS, TECHNICIANS,
WORKERS, AND ADMINISTRATIVES
PERSONNEL ARE ABLE TO PROVIDE
YOU WITH SUPERIOR NEW LIFT
INSTALLATIONS, MAINTENANCE, SERVICE
AND MODERNIZATION PROGRAMS.



CORPORATE OFFICE - AHMEDABAD

KINETIC

Lift for Life Time

KINETIC OFFER TWO DIFFERENT FLEXIBLE YEARLY CONTRACTS A FULL COMPREHENSIVE MAINTENANCE CONTRACT AND A NON-COMPREHENSIVE MAINTENANCE CONTRACT. BOTH OF THESE CONTRACTS CAN BE USED WITH ANY TYPE OF LIFT. OUR COMPREHENSIVE PREVENTIVE MAINTENANCE PROGRAM HELPS TO KEEP LIFT IN MINIMUM DOWNTIME & PROVIDE BEST RETURN OF YOUR LIFT COST. SAFE SERVICE & MAINTENANCE PLAY SIGNIFICANT ROLE IN INCREASING LIFE OF AN LIFT AS LIFT IS AN OUTPUT OF ELECTRONIC, ELECTRICAL & MECHANICAL DEVICES.

WE ASSURE THE AVAILABILITY OF COMPLETE GENUINE PARTS AT ALL OUR BRANCHES WITH COUNTRY WIDE DISTRIBUTION NETWORK. TO ENSURE OPTIMUM SAFETY AND PERFORMANCE OF YOUR LIFT IT IS IMPERATIVE THAT ROUTINE MAINTENANCE AND SERVICE CHECKS ARE IS PERFORMED. PRIMARY AIM OF COMPANY IS TO PROVIDE BEST SERVICES TO THEIR CLIENTS AS WELL AS MAINTAINING NATIONAL & INTERNATIONAL SAFETY STANDARD.

IF DURING TESTING & INSPECTION WE DISCOVER ANY PARTS NEED REPAIR OR REPLACEMENT, WE WILL ADVISE THE CUSTOMER OF COST AND THE URGENCY OF THESE ITEMS. NON-URGENT ITEMS MAY WAIT UNTIL THE NEXT REGULAR SERVICE VISIT, OTHERS MAY BE MORE URGENT OR MAKE THE LIFT UNSAFE TO USE. THIS MAY RESULT IN THE LIFT BEING TAKEN-OUT OF SERVICE WHILST WE CARRY OUT ESSENTIAL WORKS. AT EVERY STEP WE WORK TO THE CURRENT SAFETY REQUIREMENTS AND LIAISE WITH THE CUSTOMER, FORWARDING QUOTATIONS FOR APPROVAL BEFORE WORK IS COMMENCED. OUR INSTALLATION ENGINEERS AND MAINTENANCE SPECIALISTS ARE ALWAYS THERE FOR TAKING CARE OF YOUR LIFT.



EVERY KINETIC LIFT IS EQUIPPED WITH THE POWER OF MICROPROCESSOR

EVERY KINETIC PRODUCT IS OUTCOME OF CAREFUL RESEARCH & INTELLIGENT MICROPROCESSOR FOR SMOOTHER, NOISELESS AND TROUBLE FREE OPERATIONS.

THE MICROPROCESSOR IS PROGRAMMABLE INTEGRATED DEVICE WITH A SIGNIFICANT ROLE IN EVERYDAY FUNCTIONING OF MODERN INDUSTRIALIZED SOCIETIES. IT HAS COMPUTING & DECISION MAKING CAPABILITIES. SINGLE MICROPROCESSOR LOGIC BOARD CONTROLS & VIEWS THE ENTIRE LIFT FUNCTION SUCH AS CALLS, MACHINE, DOOR OPERATOR ETC. COMPLETE DIAGNOSTIC OF CONTROL SYSTEM CAN BE PERFORMED WITH THE HELP OF SEVEN SEGMENT DISPLAY PROVIDED ON MICROPROCESSOR MOTHER-BOARD. PLUS POINT OF DISPLAY IS THAT AT THE TIME OF BREAKDOWN OUR TECHNICAL ENGINEER CAN TRACE OUT SPECIFIC REPLACEABLE COMPONENTS, THUS PUTTING LIFT IN NORMAL RUNNING CONDITION WITH MINIMIZING DOWN TIME. LED STATUS INDICATORS FOR POWER SUPPLIES, LIMITS, GATE LOCKS, CAR & HALL CALLS PROVIDED ON BOARD IN PANEL.

THE HI-TECH FEATURES OF MICROPROCESSOR ENSURES ADVANCE TRAFFIC MANAGEMENT, MINIMUM WAITING TIME-INTERVAL, BEST UNINTERRUPTED PERFORMANCE RESPECTIVE OF HEAVY TRAFFIC CONDITION, LOWEST NOISE LEVEL BY ELIMINATING THE MOVING PARTS, MINIMUM ENERGY CONSUMPTION & PERFECT LEVELING.

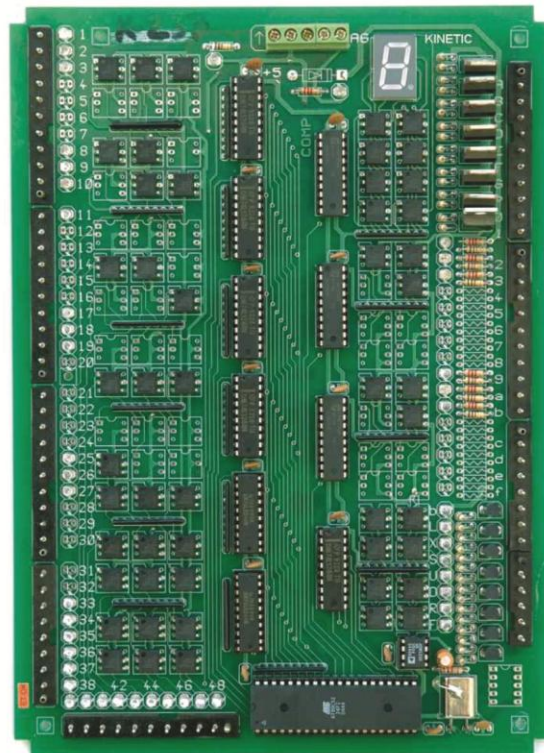

KINETIC

Lift for Life Time

DESIGN, MATERIAL CONTROL & PRODUCTION



DESIGN, MATERIAL CONTROL AND PRODUCTION AT KINETIC ARE ALL EXECUTED WITH THE AID OF OUR HIGHLY ADVANCED COMPUTER AIDED DESIGN AND MANUFACTURING SYSTEMS, EXCLUSIVELY DEVELOPED TO ENSURE RAPID RESPONSE TIMES IN DESIGN AND MANUFACTURE. WITH MORE THAN 1800 SQ. YARDS WORKS FLOOR AREA AND THANKS TO SOME INVESTMENTS MADE IN THE PAST YEARS, OUR MANUFACTURING CAPACITY HAS BEEN INCREASED.

OUR MATERIALS AND COMPONENTS COMPLY WITH RELEVANT MANUFACTURING STANDARDS AND ARE SUBJECT TO CONTINUOUS AND HIGHLY STRINGENT INCOMING INSPECTION PROCEDURES. THIS PHILOSOPHY ENSURES THAT QUALITY IS AUTOMATICALLY BUILT INTO EACH KINETIC PRODUCTS FROM START TO FINISH OF MANUFACTURE.

TO MEET THE NEW CHALLENGES OF MODERN AGE AND TO TAKE A NEXT MOVE TOWARD NEW MILLENNIUM, KINETIC PRODUCE QUALITY PRODUCTS WITH MOST ADVANCE LEVEL OF TECHNOLOGY IN REMARKABLY SHORT TIME. THIS FEEDBACK FROM FIELD PERSONNEL ALLOWS US TO CONSTANTLY IMPROVE OUR DESIGNS, PROCEDURES AND PRODUCT TO PROVIDE A BETTER LESS EXPENSIVE PRODUCT FOR OUR CUSTOMERS.

**KINETIC****Lift for Life Time**

FEATURES

S : Standard Feature O : Optional Feature

NO.	FUNCTION	FUNCTION DESCRIPTION	CONFIGURATION
1	AUTOMATIC MODE	THE ELEVATOR RUNS AUTOMATICALLY ACCORDING TO GIVEN CALLS.	S
2	MANUAL MODE	THE ELEVATOR RUNS ACCORDING TO THE INSTRUCTION GIVEN BY OPERATOR IN CAR.	S
3	EMERGENCY STOP SWITCH	IN CASE OF EMERGENCY, ELEVATOR CAN BE STOPPED AT ANY MOMENT BY PRESSING THIS BUTTON.	S
4	OVER TRAVEL PROTECTION	WHEN ELEVATOR MAKE OVER-TRAVEL, THIS DEVICE TRIP THE POWER-SUPPLY & FORCE TO STOP THE ELEVATOR.	S
5	DOOR OPEN AT LANDING	PUSH THE LANDING DOOR BUTTON TO MAKE THE DOOR OPEN AGAIN.	S
6	DOOR OPEN AT CAR	PUSH THE DOOR OPEN BUTTON IN THE CAR TO MAKE THE DOOR OPEN AGAIN.	S
7	CLOSE DOOR BUTTON	THE ELEVATOR CLOSES THE DOOR IMMEDIATELY AFTER DOOR CLOSE BUTTON IS PUSHED.	S
8	REPEATED DOOR CLOSING	IF AN OBSTACLE PREVENTS THE DOOR FROM CLOSING, THE DOOR WILL OPEN AND CLOSE REPEATEDLY UNTIL THE OBJECT IS REMOVED	S
9	PHASE SEQUENCE PROTECTION	IN CASE OF SINGLE PHASING OR PHASE SEQUENCE SCENARIO, THE ELEVATOR WILL STOP IMMEDIATELY.	S
10	OVER LOAD PROTECTION	WHEN THE ELEVATOR CROSSES FULL LOAD, THE ELEVATOR ALARMS WITH SOUND & LIGHT	O
11	OVER SPEED PROTECTION	WHEN DOWN SPEED IS CROSSES RATED SPEED, THIS DEVICE WILL CUT DOWN THE POWER AUTOMATICALLY TO STOP THE MOTOR AND THE CAR, IF THE CAR CONTINUES AT AN OVER SPEED IN DOWN DIRECTION, THE SAFETY DEVICE WILL BE ACTUATED TO FORCE THE CAR TO STOP FOR SAFETY.	S
12	CAR VENTILATION	IF THERE IS NO CALL REGISTERED WITHIN A PERIOD OF TIME, THE CAR FAN IS AUTOMATICALLY SHUT OFF TO SAVE ENERGY.	S
13	EASY DIAGNOSIS	CONTROLLER IS SO DESIGNED TO FIND MALFUNCTIONS FOR FAST TROUBLESHOOTING & DIAGNOSIS.	S
14	CAR FLOOR/DIRECTION	DISPLAY THE NUMBER OF THE ARRIVAL FLOOR AND THE UP/DOWN DIRECTION INSIDE THE CAR.	S
15	LANDING FLOOR/DIRECTION	DISPLAY THE ARRIVAL FLOOR AND OPERATION DIRECTION IN THE LANDING FLOORS.	S
16	MECHANICAL EDGE	DETECT PASSENGERS OR OBJECTS BY SENSITIVE MECHANICAL BOARD.	S
17	CAR ARRIVAL CHIME	AN ELECTRONIC CHIME INSTALLED ON THE ROOF OF THE CAR SOUNDS TO INFORM PASSENGERS THE ARRIVAL.	S
18	OPENING TIME EXTENSION	BY PRESSING THE SPECIFIC BUTTON IN THE CAR, THE DOOR WILL REMAIN OPEN FOR AN EXTENDED PERIOD OF TIME TO FACILITATE LOADING AND UNLOADING.	S
19	DOOR OPERATOR V3F DRIVE	ACCURATELY ADJUST MOTOR SPEED SO THAT DOOR OPEN/CLOSE MORE GENTLY AND SENSITIVELY.	O
20	BACKGROUND MUSIC	VOICE EQUIPMENT PLAYS MUSIC WHEN THE ELEVATOR RUNS NORMALLY.	O
21	LANDING CALL BUZZER	IN MANUAL MODE, IT GIVES INDICATIONS TO OPERATOR TO ATTEND LANDING CALLS.	O
22	OVER CURRENT PROTECTION	IN CASE OF OVER CURRENT, MOTOR WILL TRIP IMMEDIATELY.	O
23	REMOTE MONITORING	THROUGH MODEM AND PHONE, THE ELEVATOR CAN BE CONTROLLED AND MONITORED REMOTELY, WHICH IS CONVENIENT FOR MANUFACTURER AND SERVICE PERSON TO FIND OUT THE CONDITION OF EACH ELEVATOR FOR IMMEDIATE SERVICE.	O
24	VVVF DRIVE	ACCURATELY ADJUST SPEED IN ACCELERATION & DECELERATION FOR MORE SMOOTH & COMFORT TRAVEL	O
25	COLLECTIVE SELECTIVE	THE CAR WILL ATTEND (COLLECT) THE ALL FLOORS WHICH ARE SELECTED BY PASSENGERS WHILE GOING TO UP OR DOWN DIRECTION.	O
26	FIREMAN SWITCH	WHEN THE FIREMAN SWITCH IS PRESSED, ALL REGISTERED CALL WILL BE CANCELLED AND THE CAR IS IMMEDIATELY CALLED TO THE SPECIFIED RESCUE FLOOR.	O
27	EMERGENCY ALARM FUNCTION	IN CASE OF EMERGENCY IN LIFT, EMERGENCY ALARM CAN BE HEARD AT BUILDING CONTROL-ROOM AT GROUND FLOOR.	O
28	EMERGENCY LIGHT FUNCTION	WHEN POWER-SUPPLY FAILS, EMERGENCY LIGHT WILL BE SWITCHED ON INSTANTLY.	O
29	DUPLEX / GROUP CONTROL	DUPLEX OR GROUP CONTROL CAN BE ARRANGED FOR TWO OR MORE LIFTS FOR EFFECTIVE & ADVANCE TRAFFIC MANAGEMENT.	O
30	LIFT MANAGEMENT SYSTEM	LMS IS USEFUL FOR VIEWING, ANALYZING, & CONTROLLING THE DIFFERENT TYPES OF SINGLE OR MULTIPLE LIFTS.	O
31	KINETIC RESCUE SYSTEM	IN CASE OF POWER FAILURE, PHASE REVERSAL/IMBALANCE. KRS BRING THE LIFT SYSTEM & BRING THE LIFT DOWN TO NEAREST FLOOR.	O
32	INFRA-RED DOOR CURTAINS	MULTIPLE INFRARED BEAMS WHICH COVER THE FULL HEIGHT OF DOOR TO DETECT PASSENGER/OBJECTS AS DOORS OPEN/CLOSE.	O
33	INTER-COM	TWO WAY TELEPHONE SYSTEM IS PROVIDED IN CAR FOR COMMUNICATION BETWEEN BUILDING-CONTROL-ROOM & CAR.	O
34	VOICE ANNUNCIATION DEVICE	THIS SYSTEM IN CAR WILL ANNOUNCE FLOOR ARRIVAL, WELCOMING MESSAGES	O



KINETIC

Lift for Life Time

Hall Door

KINETIC ELEVATOR PROVIDES RANGE OF ELEGANT , DECENT & MAGNIFICENT HALL DOOR AND CAR DOOR MODELS WHICH MATCH WITH BEAUTIFUL SIGHT OF MODERN ARCHITECTURE STYLES.

AUTOMATIC DOORS :

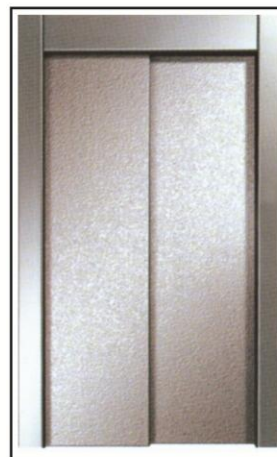

MANUAL DOORS :



TELESCOPIC DOOR



COLLAPSIBLE DOOR



WOODEN SWING DOOR



IMPERFORATED DOOR

CAR INTERIOR



KE-HCS-P13



KE-HCS-R01



KE-HCS-R02



KE-HCS-R03

KINETIC

Lift for Life Time



KE-HCS-P23

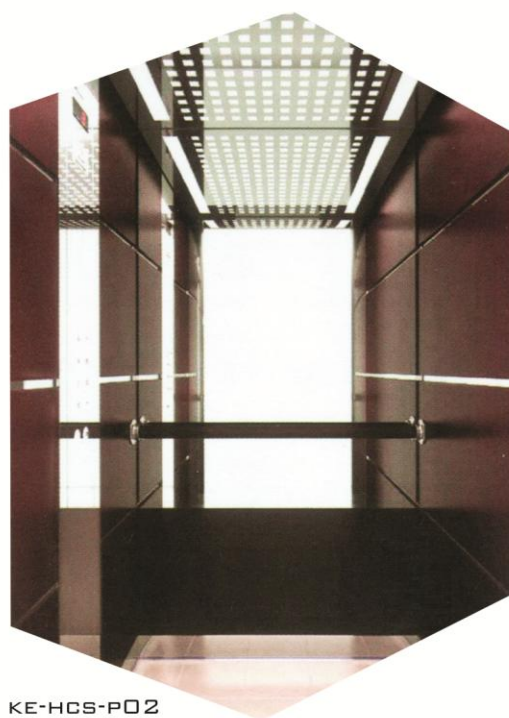

KE-HCS-P02



KE-HCS-E02



KE-HCS-M03

CAR INTERIOR



KE-HCS-P33



KE-HCS-E01



KE-HCS-P01

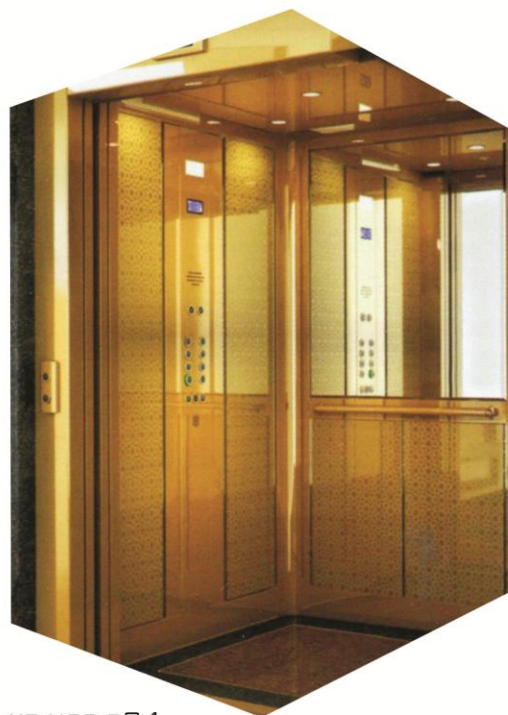

KE-HCS-R04

KINETIC

Lift for Life Time

DECORATION MATERIAL & COLOUR SELECTION

ENAMEL PAINT



KEP107S



KEP108S



KEP109S



KEP010S



KEP011S



KEP012S

STAINLESS STEEL (OPTIONAL/PRICE EXTRA)



KES207E



KES208E



KES209E



KES210E

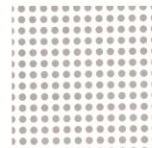

KES211E



KES212E



KES213E



KES214E



KES215E



KES216E



KES217E



KES218E

LAMINATED SHEET



KEW307S



KEW308S



KEW309S



KEW310S



KEW311S

CAR FLOORING



KEF407S



KEF407S



KEF407S



KEF407S



KEF407S



KEF407S

CEILING (OPTIONAL/PRICE EXTRA)



KEC507E



KEC508E



KEC509E

NOTATIONS :

1. THE STYLE IN THIS DECORATION IS THE STANDARD PATTERN IN OUR COMPANY. IF A SPECIAL DECORATION IS REQUIRED BY CLIENT, WE WILL DESIGN AND MANUFACTURE ACCORDING TO CLIENT'S REQUIREMENT. IT IS OUR PLEASURE TO MEET CLIENT'S DEMAND WITH THE KINETIC PROFESSIONAL DESIGN TECHNIQUES.
2. DIAGRAMS IN THIS CATALOGUE ARE PREPARED BY THE COMPUTER, THEREFORE SOME DIFFERENCES MAY EXISTS BETWEEN PICTURES & ITS ORIGINAL OBJECTS.
3. ALL INFORMATION ARE FOR REFERENCE AND INITIAL PLANNING ONLY. THE PHOTOGRAPHS AND DRAWINGS ARE GENERAL ILLUSTRATION OF OUR PRODUCTS. FOR SPECIFIC CONSTRUCTION DETAILS, PLEASE CONTACT KINETIC'S LOCAL SALES OFFICE. SOME OF THE ILLUSTRATIONS ARE IS SUBJECT TO CHANGE WITHOUT PRIOR NOTICE.

CAR INTERIOR

Signalling Fixture

BASED ON BODY-ENGINEERING, KINETIC OPERATING PANEL REFLECTS INTEGRAL DESIGN CONCEPT FOR THE CUSTOMER AND ARTISTIC DECORATION OF CAR. EXQUISITE & OUTSTANDING TOUCH SENSOR BUTTON HAS MANY ADVANTAGE OF COMFORTABLE FEELING, CLEAR SCREEN, LEDMONITOR WHICH IS EASY TO SCAN.

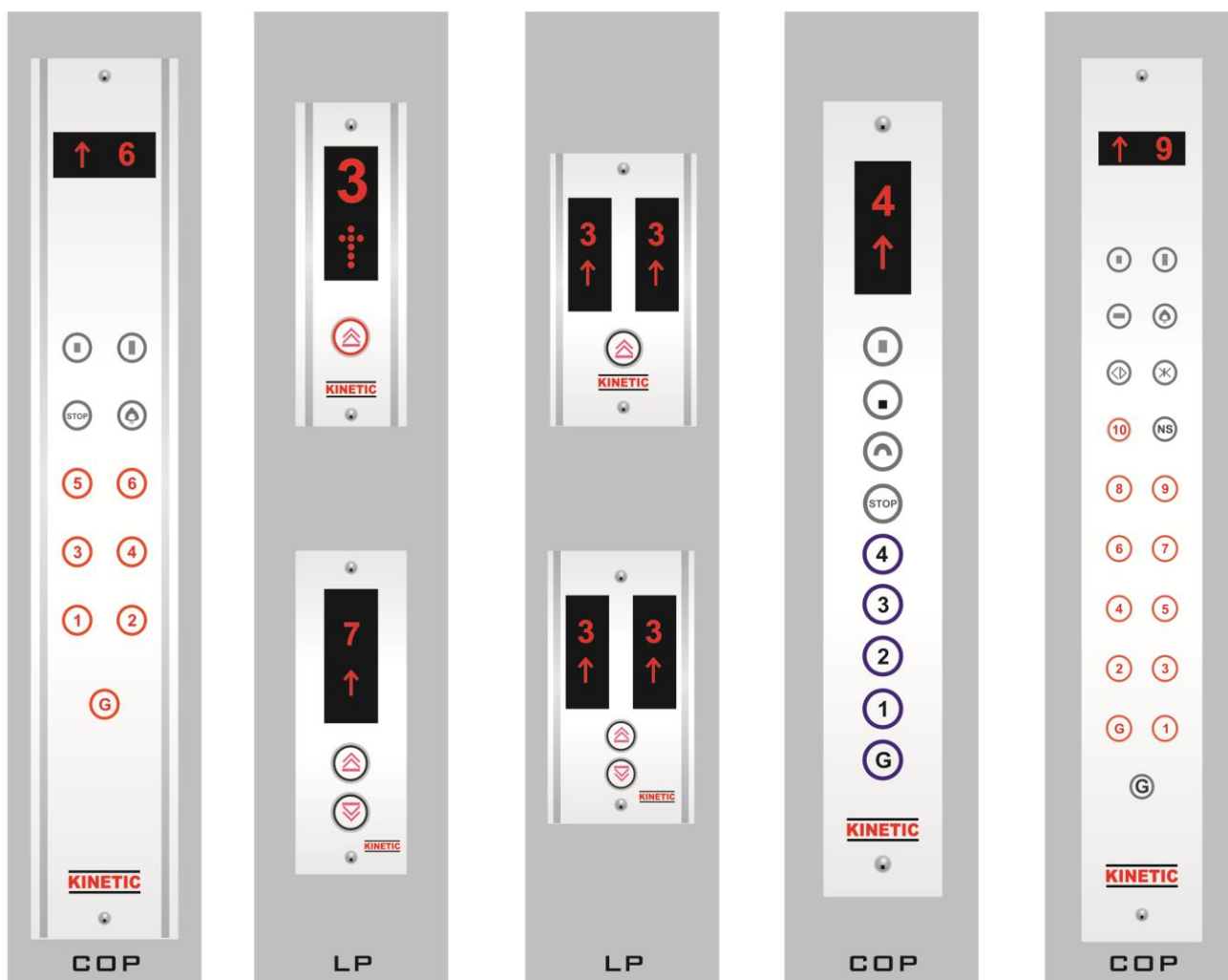

KINETIC

Lift for Life Time

MODERNIZE YOUR EXISTING LIFT SYSTEM

MAKE AN OLD LIFT'S PERFORMANCE AND APPEARANCE LIKE NEW AGAIN WITH OUR MODERNIZATION PACKAGES THAT IS COST & TIME EFFICIENT. OUR STATE-OF-ART MODERNIZE KIT WILL CONVERT CONVENTIONAL TYPE OF LIFTS INTO WORLD CLASS LIFT SYSTEM WITH LESS POWER-CONSUMPTION, TROUBLE-FREE OPERATION, MINIMIZED WAITING TIME AND PERFECT LEVELING ACCURACY. REDUCTION IN MAINTENANCE COST DUE TO MODERN TECHNOLOGY IS ANOTHER REASON FOR MODERNIZING YOUR LIFT.

KINETIC HAS IMPLEMENTED ITS EXPERIENCES FOR REDESIGNING AND MODERNIZING YOUR EXISTING LIFT SYSTEM TO MEET YOUR CHANGING NEEDS & GOVERNMENT REGULATIONS. WE WILL PREPARE A COMPREHENSIVE DETAILS OF EXISTING LIFT WHICH INCLUDES PRESENT CONDITION OF LIFT, LIST OF TOTAL REPLACEABLE PARTS. THIS DETAILS ARE BEING SENT TO OUR MAINTENANCE DIVISION. WE WILL WORK OUT FOR BEST AVAILABLE OPTIONS FOR MODERNIZING THE LIFT WITH MAINTAINING SAFETY STANDARD.

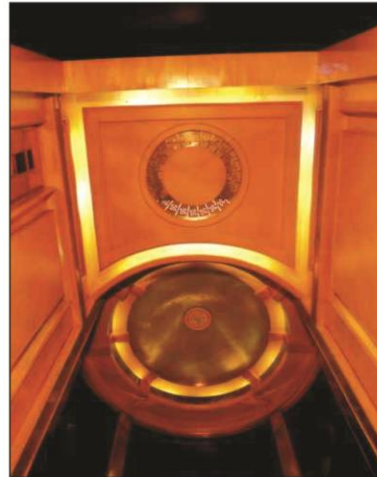

TOP VIEW

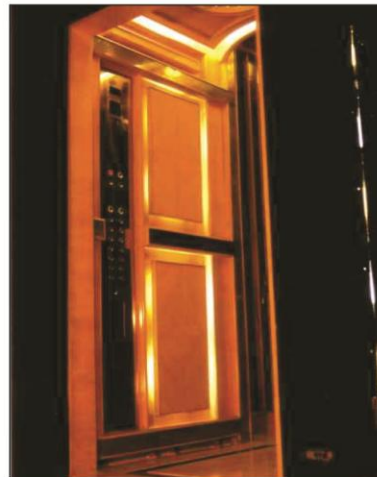

INSIDE VIEW

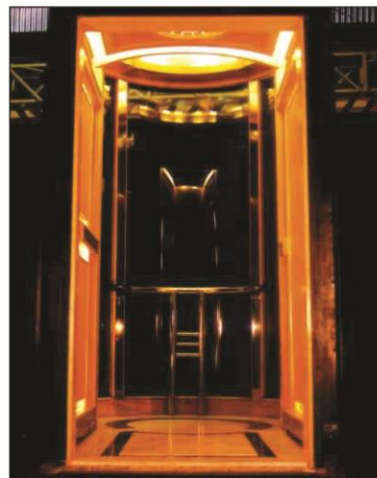

FRONT VIEW

PASSENGER VVVF LIFT

KINETIC HAS BEEN INSTALLING AND SERVICING LIFTS FOR MORE THAN A DECADE. KINETIC OFFER PASSENGER LIFT WITH MINIMUM BRAKEDOWN CALLS, SHORTER WAITING TIME & DOWNTIME.

KINETIC PASSENGER LIFT REFLECTS THE FEATURES OF SAFE, EFFICIENCY AND PRACTICALLY LOW ENERGY CONSUMPTION WITH THE INTRODUCTION OF VVVF TECHNOLOGY.

STANDARDS

LOAD : 272 KGMS. (4 PERSONS)
408 KGMS. (6 PERSONS)
544 KGMS. (8 PERSONS)
680 KGMS. (10 PERSONS)
884 KGMS. (13 PERSONS)
1088 KGMS. (16 PERSONS)

SPEED (M/S) : 0.65, 1, 1.5, 2, 2.5



S. L. TOWER- G. NOIDA



THE UNITED CGHS - MOHALI



SHANTI SAHKARI - GHAZIABAD



KWALITY BUILDERS - PUNE



GURUDWARA IMLI SAHEB - INDORE



THEATRE CENTER - KOLKATA

Passenger Elevator

HOOK(CUSTOMER PROVIDE)
2000 kgs. HOOK BEAR

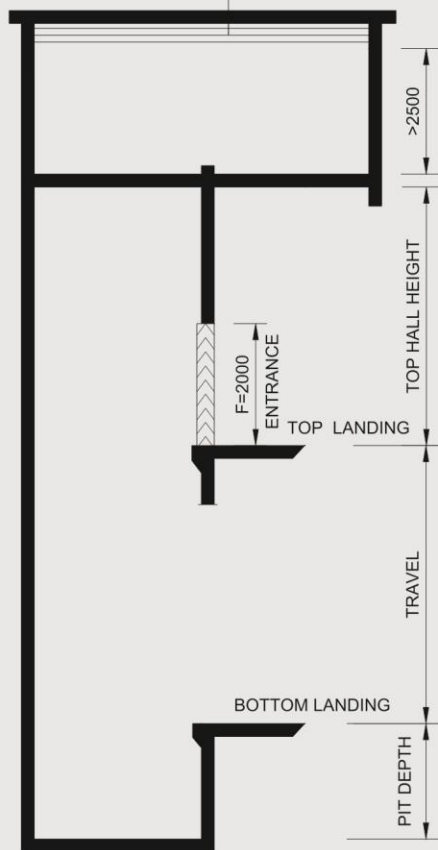

ELEVATION

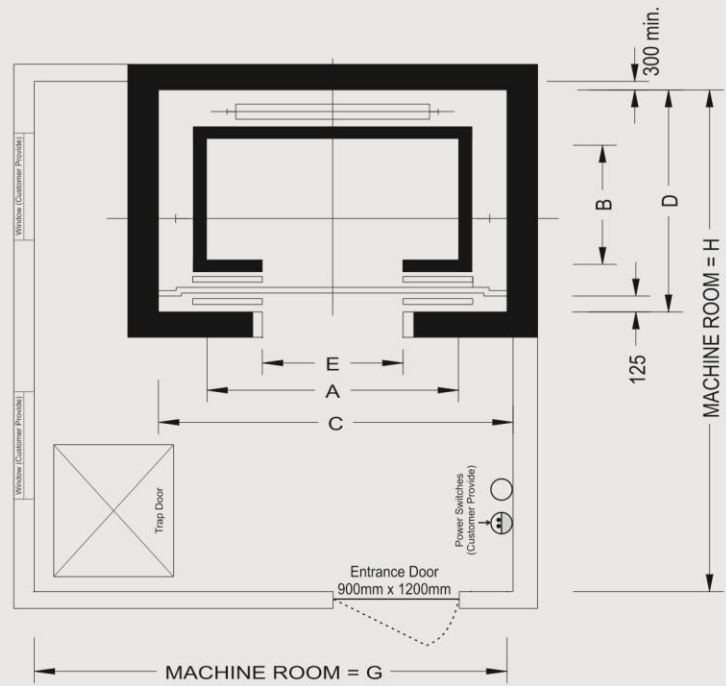

PLAN

FOR AUTOMATIC DOORS :

LOAD		CAR INSIDE		LIFT WELL		ENTRANCE
PERSONS	KG	A	B	C	D	E
4	272	1100	700	1900	1300	MIN. 700
6	408	1100	1000	1900	1700	MIN. 700
8	544	1300	1100	1900	1900	800
10	680	1350	1300	1900	2100	800
13	884	2000	1100	2500	1900	900
16	1088	2000	1300	2500	2100	1000
20	1360	2000	1550	2500	2400	1000

FOR MANUAL DOORS :

4	272	1100	700	1500	1300	800
6	408	1100	1000	1600	1500	800
8	544	1300	1100	1700	1700	800

SPEED IN MPS	UPTO 0.65	> 0.65 ≤ 1.00	> 1.00 ≤ 1.50	> 1.50 ≤ 1.75	> 1.75 ≤ 2.00	> 2.00 ≤ 2.05
PIT DEPTH	1350	1500	1600	2150	2200	2500
TOP HALL HEIGHT	4200	4250	4800	4800	5200	5400
MACHINE ROOM DEPTH	D + 2000	D + 2000	D + 2000	D + 2500	D + 2500	D + 2500
MACHINE ROOM WIDTH	C + 1000	C + 1000	C + 1200	C + 1200	C + 1500	C + 1500

NOTATIONS :

1. ALL DIMENSIONS ARE IN MILLIMETERS.
2. THE TOTAL HEADROOM HAS BEEN CALCULATED ON THE BASIS OF CAR HEIGHT OF 2.3 MTRS.
3. IN CASE OF MANUALLY-OPERATED DOORS, CLEAR ENTRANCE WILL BE REDUCED BY THE AMOUNT OF PROJECTION OF HANDLE ON THE LANDING DOOR.
4. MINIMUM FLOOR TO FLOOR HEIGHT FOR LANDING ON SAME SIDE FOR HORIZONTLY SLIDING DOOR IS $F+750\text{MM}$ & FOR VERTICALLY BI-PARTING DOORS IS $1.5F+250\text{MM}$, WHERE "F" IS CLEAR ENTRANCE HEIGHT IN MM.
5. FOR NON STANDARD LIFT WELL, PLEASE CONSULT KINETIC ELEVATORS LTD..
6. ALL INFORMATION ARE FOR REFERENCE AND INITIAL PLANNING ONLY. THE PHOTOGRAPHS AND DRAWINGS ARE GENERAL ILLUSTRATION OF OUR PRODUCTS. SPECIFIC CONSTRUCTION DETAILS, PLEASE CONTACT KINETIC'S LOCAL SALES OFFICE. KINETIC RESERVE THE RIGHT TO ALTER SOME OF THE SPECIFICATION AND DESCRIPTION GIVEN HERE IN WITHOUT PRIOR NOTICE.

OBSERVATION LIFT

TODAY'S MOST EXCLUSIVE PROJECTS ARE BEING EXECUTED IN TIME-COMMITTED INTERVAL. KINETIC NEVER COMPROMISE ON COMMITMENT AS IT PUTS ITS EXPERTISE IN CREATING ATTRACTIVE AND SPECTACULAR SCENIC LIFT IN VERTICAL TRANSPORTATION.

EYE-CATCHING EXTERIOR AND DAZZLING INTERIOR OF SCENIC LIFTS ADDS JEWEL IN YOUR PRESTIGE AND ALSO ATTRACTS MORE TRAFFIC TO HOTELS. COMMERCIAL PREMISES, THEATRES, DEPARTMENTAL STORE & SHOPPING MALLS, RESIDENTIAL PREMISES WHERE DELICACY & LUXURY CAN NOT BE COMPROMISED.

WITH THE INTRODUCTION OF VVVF TECHNOLOGY, FEATURES LIKE PRECISE LEVELING ACCURACY, JERKLESS STARTING & STOPPING, HIGHER ENERGY-SAVING CAN BE REMARKABLY ACHIEVED IN OUR OBSERVATION LIFTS.

STANDARDS

LOAD : 544 KGMS. (8 PERSONS)
680 KGMS. (10 PERSONS)
884 KGMS. (13 PERSONS)
1088 KGMS. (16 PERSONS)
1360 KGMS. (20 PERSONS)

SPEED (M/S) : 0.65, 1, 1.5, 2, 2.5



KINETIC

Lift for Life Time

Observation Elevator

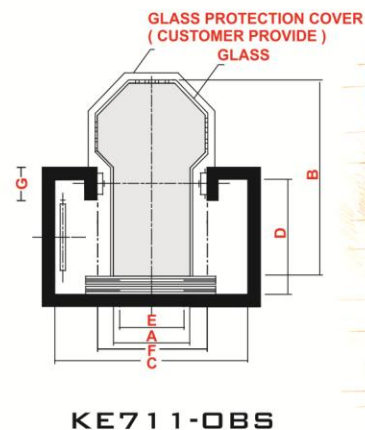
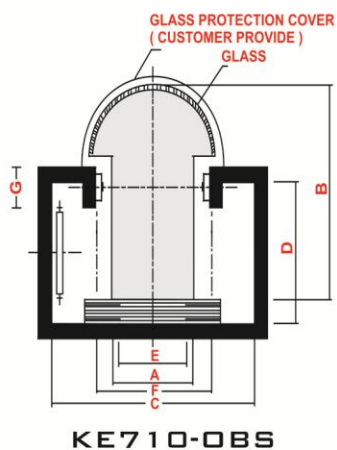
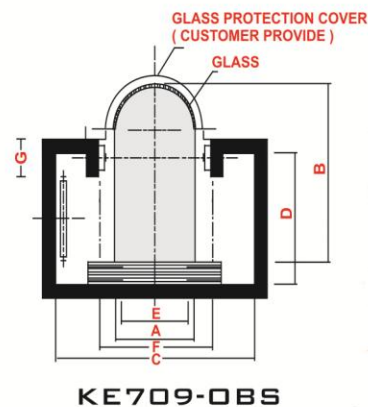
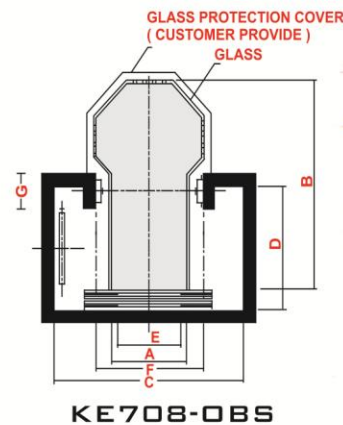
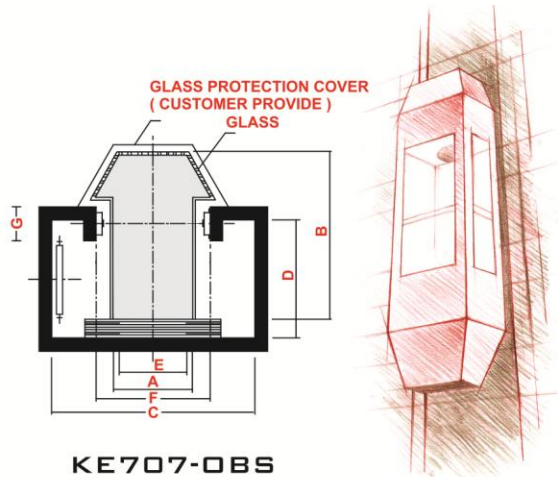

PLAN

OUTLINE DIMENSIONS

Observation Elevator

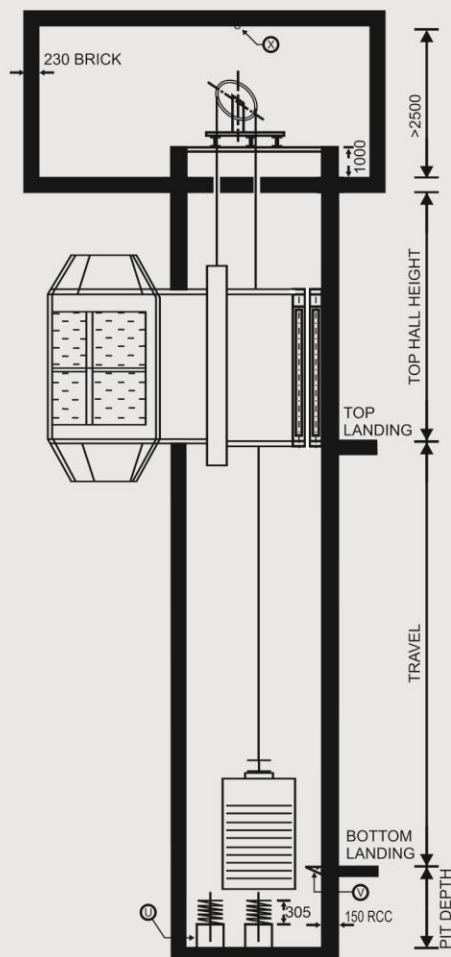

ELEVATION

LOAD HOOK DETAILS - X

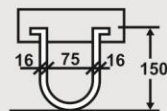

QUANTITY = 1 NOS.

PROVIDED BY CLIENT

BUFFER FOUNDATION DETAILS - U

300 X 300 X 600 mm. HEIGHT
RCC BLOCK
FOR CAR AND COUNTER
BUFFER SPRING

PROVIDED BY CLIENT

RCC SECTION DETAILS - V

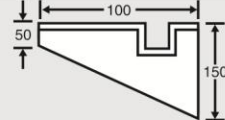

IF RCC IS NOT THERE, THEN
100 X 50 CHANNEL SHOULD BE
PROVIDED FOR FIXING THE BOTTOM SEAL.

PROVIDED BY CLIENT

LOAD		CAR INSIDE			LIFT WELL			ENTRANCE
PERSONS	KGS.	A	B	C	D	F	G	E
8	544	850	1950	2350	1200	1300	400	800
10	680	950	2050	2650	1250	1400	400	900
13	884	1050	2200	2650	1300	1500	400	900
16	1068	1100	2450	2750	1350	1550	400	1000
20	1360	1250	2550	2750	1400	1700	400	1000

NOTATIONS :

1. ALL DIMENSIONS ARE IN MILLIMETERS.
2. THE TOTAL HEADROOM HAS BEEN CALCULATED ON THE BASIS OF CAR HEIGHT OF 2.3 MTRS.
3. IN CASE OF MANUALLY-OPERATED DOORS, CLEAR ENTRANCE WILL BE REDUCED BY THE AMOUNT OF PROJECTION OF HANDLE ON THE LANDING DOOR.
4. FOR NON STANDARD LIFT WELL, PLEASE CONSULT KINETIC ELEVATORS LTD..
5. ALL INFORMATION ARE FOR REFERENCE AND INITIAL PLANNING ONLY. THE PHOTOGRAPHS AND DRAWINGS ARE GENERAL ILLUSTRATION OF OUR PRODUCTS. SPECIFIC CONSTRUCTION DETAILS, PLEASE CONTACT KINETIC'S LOCAL SALES OFFICE. KINETIC RESERVE THE RIGHT TO ALTER SOME OF THE SPECIFICATION AND DESCRIPTION GIVEN HERE IN WITHOUT PRIOR NOTICE.

GOODS LIFTS ARE PERFECT SUITABLE SOLUTION FOR THE INSTALLATIONS WHERE BULKABLE COMMODITIES/GOODS NEEDED TO TRANSPORT VERTICALLY LIKE WORK-SHOPS, SHOW-ROOM, INDUSTRIES ETC.

HIGHER ENERGY-SAVING IS ACHIEVED IN KINETIC GOODS LIFT BY LOWER STARTING CURRENT, LOWER ENERGY CONSUMPTION & HIGHER POWER FACTOR (UP TO 0.95) FEATURES WITH THE INTRODUCTION OF VVVF TECHNOLOGY. NO MOTOR OVER-HEATING CHARACTERISTIC & STOPPING OF LIFT IS DONE BY PERFECT ELECTRICAL BRAKING UNIT FOR MINIMIZING FOR MECHANICAL WEAR & TEAR & MAINTENANCE-FREE PERFORMANCE FOREVER.

STANDARDS

LOAD (KGS.) : 500, 1000, 1500, 2000, 2500, 3000, 4000, 5000, 10000

SPEED (M/S) : 0.30, 0.50, 1, 1.5

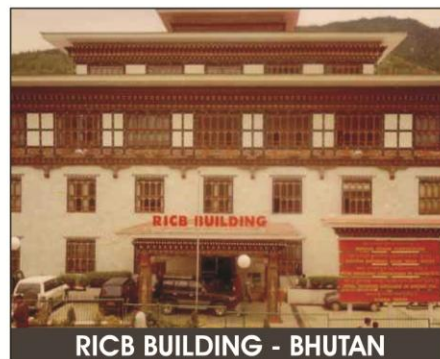

RICB BUILDING - BHUTAN

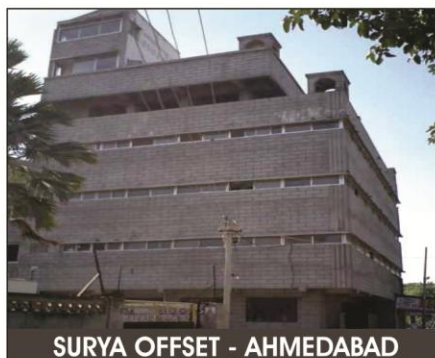

SURYA OFFSET - AHMEDABAD

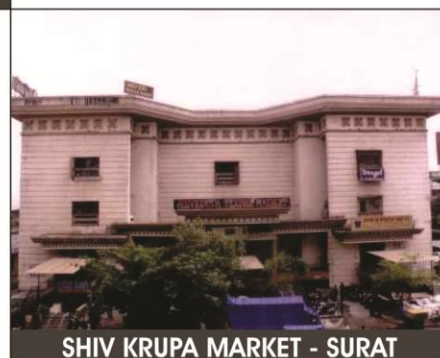

SHIV KRUPA MARKET - SURAT

OUTLINE DIMENSIONS

Goods Elevator

HOOK(CUSTOMER PROVIDE)
3000 kgs. HOOK BEAR

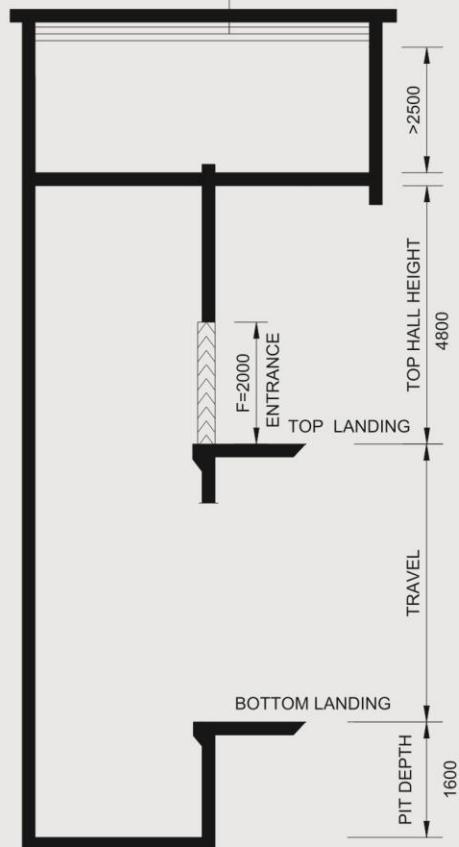

ELEVATION

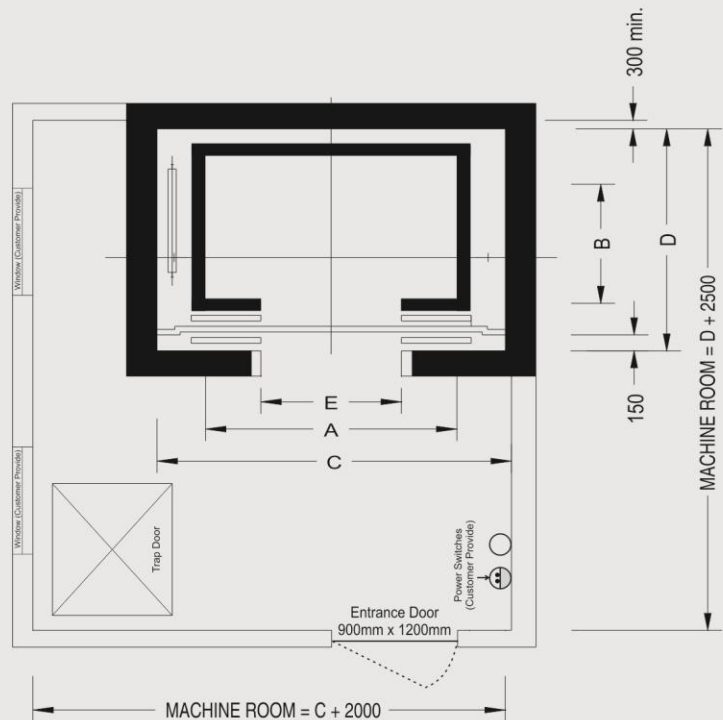

PLAN

LOAD	CAR INSIDE		LIFT WELL		ENTRANCE
KG	A	B	C	D	E
500	1100	1200	1900	1500	1100
1000	1400	1800	2300	2100	1400
1500	1700	2000	2600	2300	1700
2000	1700	2500	2600	2800	1700
2500	2000	2500	2900	2800	2000
3000	2000	3000	2900	3300	2000
4000	2500	3000	3400	3300	2500
5000	2500	3600	3400	3900	2500

NOTATIONS :

1. ALL DIMENSIONS ARE IN MILLIMETERS.
2. THE TOTAL HEADROOM HAS BEEN CALCULATED ON THE BASIS OF CAR HEIGHT OF 2.2 MTRS.
3. THE WIDTH OF MACHINE-ROOM SHALL BE EQUAL TO THE LIFT WELL WIDTH "C" SUBJECT TO MINIMUM OF 2500MM.
4. FOR NON STANDARD LIFT WELL, PLEASE CONSULT KINETIC ELEVATORS LTD..
5. ALL INFORMATION ARE FOR REFERENCE AND INITIAL PLANNING ONLY. THE PHOTOGRAPHS AND DRAWINGS ARE GENERAL ILLUSTRATION OF OUR PRODUCTS. SPECIFIC CONSTRUCTION DETAILS, PLEASE CONTACT KINETIC'S LOCAL SALES OFFICE. KINETIC RESERVE THE RIGHT TO ALTER SOME OF THE SPECIFICATION AND DESCRIPTION GIVEN HERE IN WITHOUT PRIOR NOTICE.

OUTLINE DIMENSIONS

Service Elevator

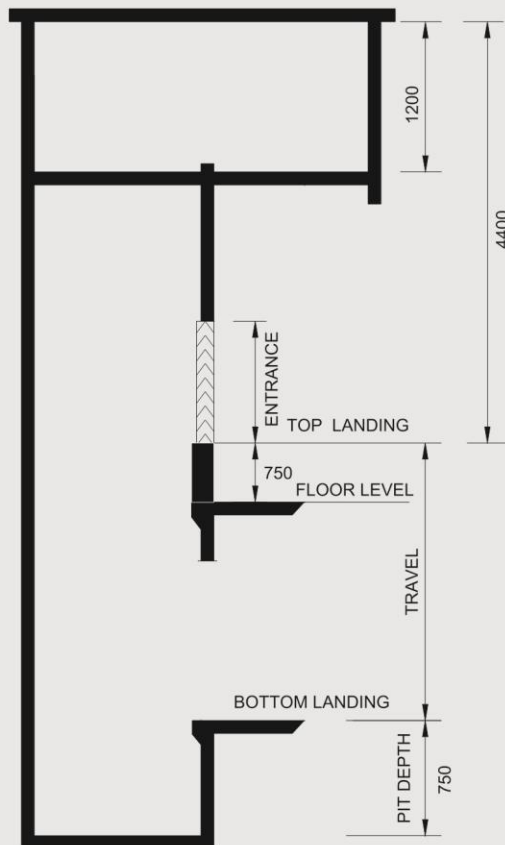

ELEVATION

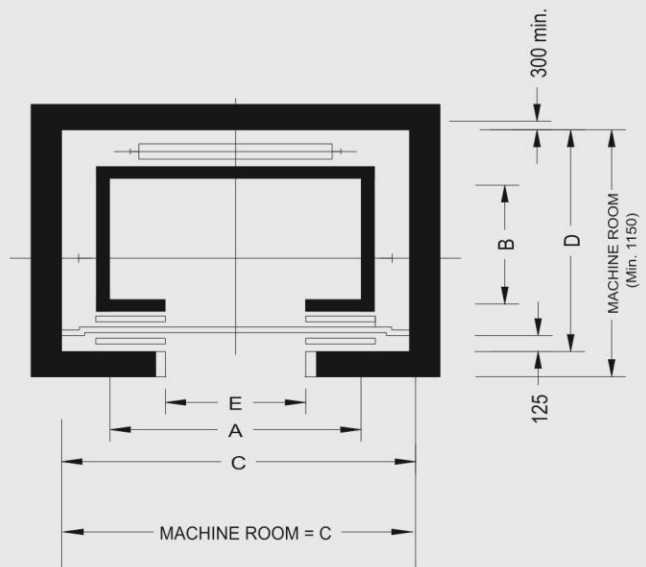

PLAN

LOAD	CAR INSIDE			LIFT WELL		ENTRANCE
KG	A	B	E	C	D	E
100	700	700	800	1200	900	700
150	800	800	900	1300	1000	800
200	900	900	1000	1400	1100	900
250	1000	1000	1200	1500	1200	1000

NOTATIONS :

1. ALL DIMENSIONS ARE IN MILLIMETERS.
2. ENTRANCE WIDTH "E" IS BASED ON ASSUMPTION OF PROVISION OF VERTICAL BI-PARTING DOORS (NO CAR DOOR IS NORMALLY PROVIDED).
3. FOR NON STANDARD LIFT WELL, PLEASE CONSULT KINETIC ELEVATORS LTD..
4. ALL INFORMATION ARE FOR REFERENCE AND INITIAL PLANNING ONLY. THE PHOTOGRAPHS AND DRAWINGS ARE GENERAL ILLUSTRATION OF OUR PRODUCTS. SPECIFIC CONSTRUCTION DETAILS, PLEASE CONTACT KINETIC'S LOCAL SALES OFFICE. KINETIC RESERVE THE RIGHT TO ALTER SOME OF THE SPECIFICATION AND DESCRIPTION GIVEN HERE IN WITHOUT PRIOR NOTICE.

HOSPITAL LIFT

KINETIC PRODUCED HI-TECH HOSPITAL LIFTS THAT IS SUPERIOR IN DESIGN, COMPACT STRUCTURE & PERFORMANCE.

IN ORDER TO HAVE SMOOTH & JERKLESS STARTING & STOPPING, ECONOMICALLY LOW POWER-CONSUMPTION, KINETIC INTRODUCES MILLENNIUM MOST ADVANCED ENERGY-SAVING VVVF TECHNOLOGY IN HOSPITAL LIFTS THAT GUARANTEES THROUGHOUT THE LIFE . VVVF TECHNOLOGY ENSURES BEST RETURN OF COST.

STANDARDS

LOAD : 1020 KGMS. (15 PERSONS)
1360 KGMS. (20 PERSONS)
1768 KGMS. (26 PERSONS)

SPEED (M/S) : 0.30, 0.60, 1, 1.5, 2, 2.5



DR. HARADIA HOSPITAL - INDORE

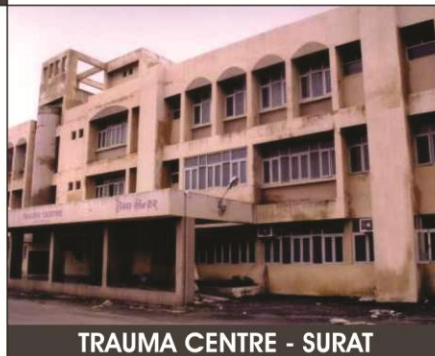

TRAUMA CENTRE - SURAT

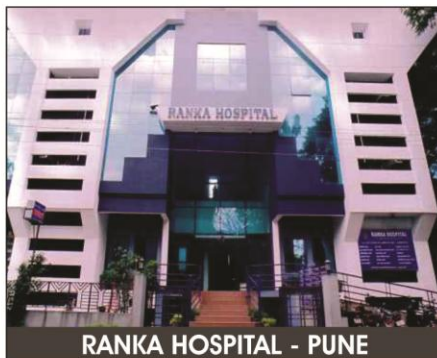

RANKA HOSPITAL - PUNE

Hospital Elevator

HOOK(CUSTOMER PROVIDE)
2000 kgs. HOOK BEAR

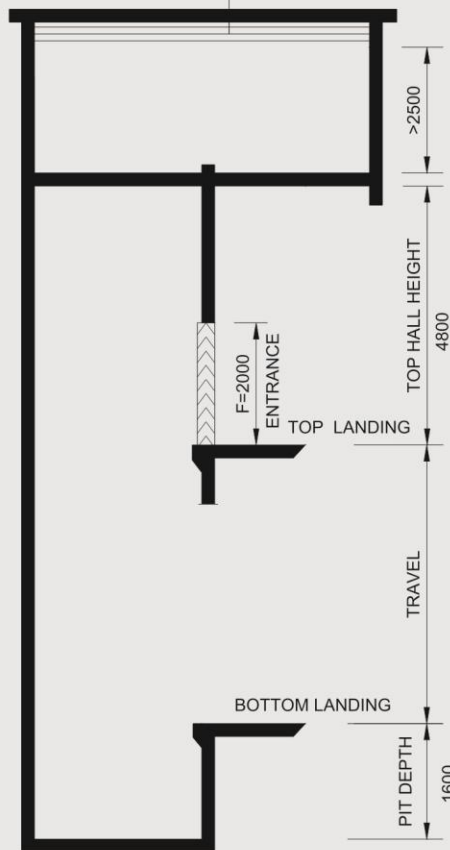

ELEVATION

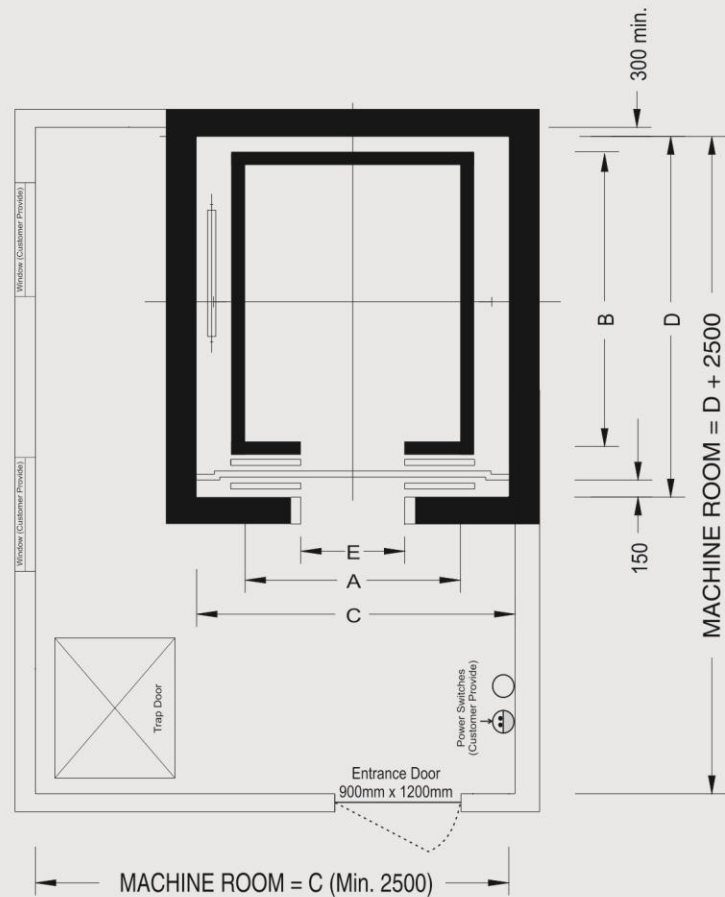

PLAN

LOAD		CAR INSIDE		LIFT WELL		ENTRANCE
PERSONS	KG	A	B	C	D	E
15	1020	950	2400	1800	3000	800
20	1360	1300	2400	2200	3000	1200
26	1768	1600	2400	2350	3000	1200

NOTATIONS :

1. ALL DIMENSIONS ARE IN MILLIMETERS.
2. THE TOTAL HEADROOM HAS BEEN CALCULATED ON THE BASIS OF CAR HEIGHT OF 2.3 MTRS.
3. IN CASE OF MANUALLY-OPERATED DOORS, CLEAR ENTRANCE WILL BE REDUCED BY THE AMOUNT OF PROJECTION OF HANDLE ON THE LANDING DOOR.
4. FOR NON STANDARD LIFT WELL, PLEASE CONSULT KINETIC ELEVATORS LTD..
5. ALL INFORMATION ARE FOR REFERENCE AND INITIAL PLANNING ONLY. THE PHOTOGRAPHS AND DRAWINGS ARE GENERAL ILLUSTRATION OF OUR PRODUCTS. SPECIFIC CONSTRUCTION DETAILS, PLEASE CONTACT KINETIC'S LOCAL SALES OFFICE. KINETIC RESERVE THE RIGHT TO ALTER SOME OF THE SPECIFICATION AND DESCRIPTION GIVEN HERE IN WITHOUT PRIOR NOTICE.

MACHINE ROOM LESS (MRL) LIFT



KINETIC PMSM GEARLESS ELEVATOR IS AVAILABLE WITH & WITHOUT MACHINE ROOM OPTION. IT OPERATES ON SINGLE-PHASE 230 V POWER SUPPLY.

THE MACHINE IS LOCATED WITHIN THE SHAFT ITSELF WITHOUT REQUIRING ADDITIONAL SPACE. THE INTERNAL SHAFT DIMENSIONS, THE PIT, AND THE HEADROOM ARE IDENTICAL TO CONVENTIONAL STANDARD ELEVATOR SPECIFICATION. KINETIC MRL ELEVATOR NEEDS NO LOAD-BEARING SHAFT WALLS AND THE PIT, WHERE ALL VERTICAL AND HORIZONTAL FORCES AS WELL AS VIBRATIONS AND NOISE ARE ABSORBED..

THE OWNER OF A BUILDING CAN DO WITHOUT A MACHINE ROOM AND BENEFITS FROM MORE SPACE. THE ARCHITECT BENEFITS FROM ADDITIONAL DESIGN FREEDOM AND DOES NOT NEED SPECIAL LOAD BEARING SHAFT WALLS.



ADVANTAGES OF GEARLESS ELEVATOR :

- IDEAL PRODUCT FOR SHOP-OFFICE AND RESIDENTIAL APPLICATIONS.
- CAPACITY AVAILABLE UPTO 2000 KGS. & SPEED UPTO 2.5 M/S.
- NO MACHINE ROOM REQUIRED. THE MACHINE IS HOUSED WITHIN THE HOISTWAY, ALLOWING A MORE FLEXIBLE BUILDING DESIGN WHILST REDUCING CONSTRUCTION COST AND TIME.
- COMPACT AND LIGHTWEIGHT DESIGN, TO FIT WITHIN MINIMUM SPACE, WITH LOW HEADROOM AND PIT REQUIREMENT.
- SUPPORTING HOISTWAY STEEL STRUCTURE INCLUDED AS STANDARD FEATURE, REDUCING BUILDING WORK, AND EXPEDITING INSTALLATION WORK.
- AUTOMATIC / MANUAL DOORS FOR LANDINGS AND CAR AS STANDARD FEATURE.
- EXCELLENT ENERGY SAVING FEATURES
- MAINTENANCE IS VIA A PANEL LOCATED AT FLOOR LEVEL.

HYDRAULIC ELEVATOR

Hydraulic Home Elevator

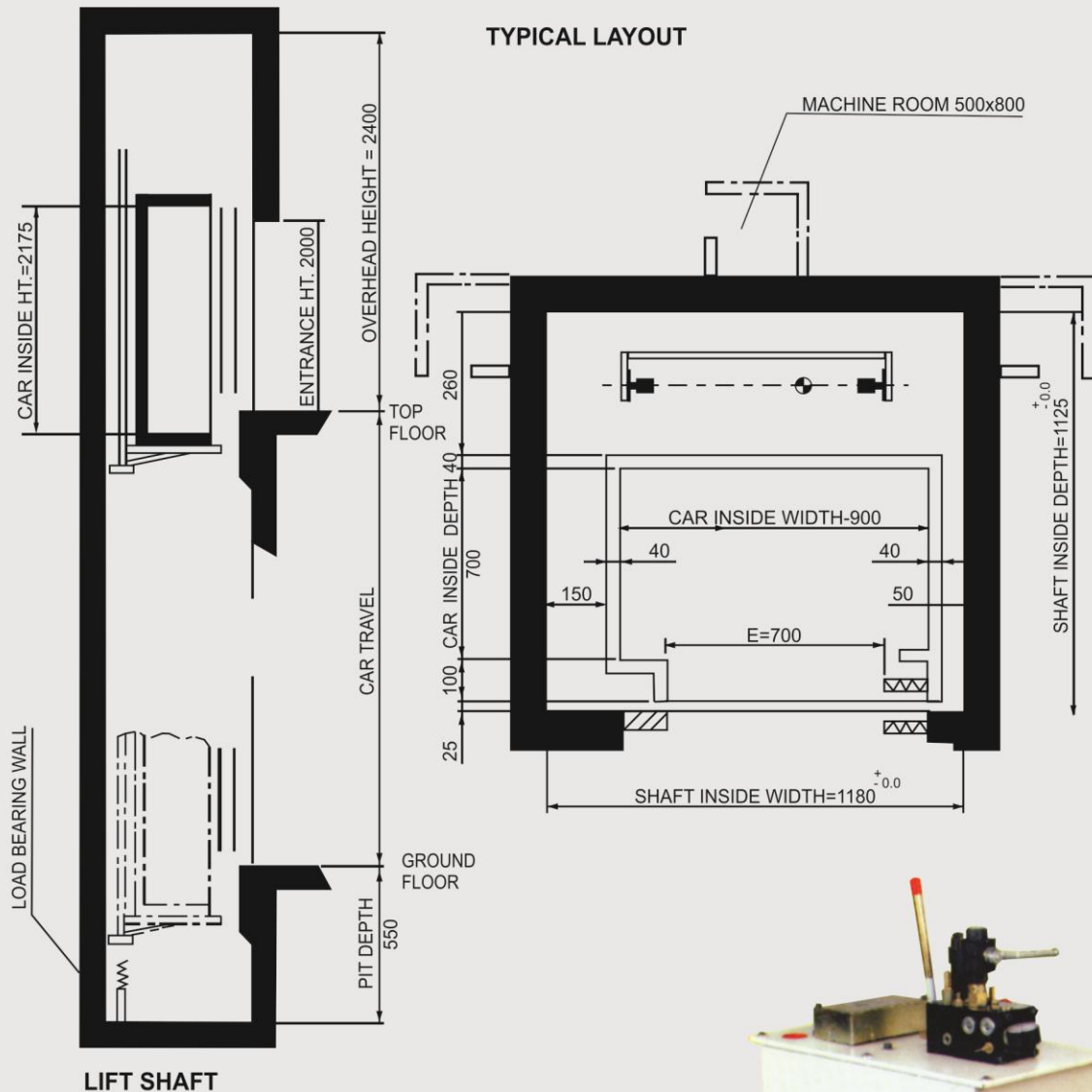

SPECIFICATIONS

Capacity : 3 Passengers (Max.204 Kgs.)
Cabin Weight : 230 Kgs. (Max.)
Travel : 8.6 meters (Max.)
Speed : 0.2 meters / sec
Power Supply : Single Phase 230 Volts, 50 Hz

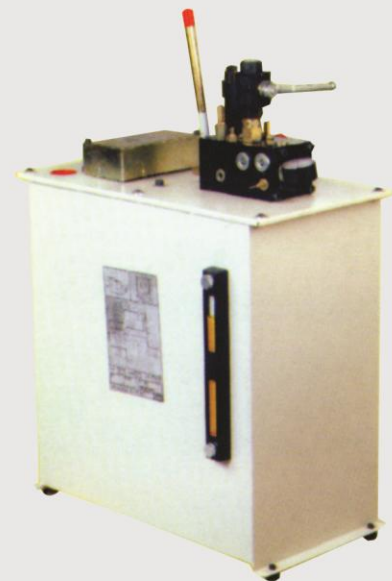

HYDRAULIC POWER UNIT - HL 6000
(540 mm W x 290 mm D x 545 mm H)

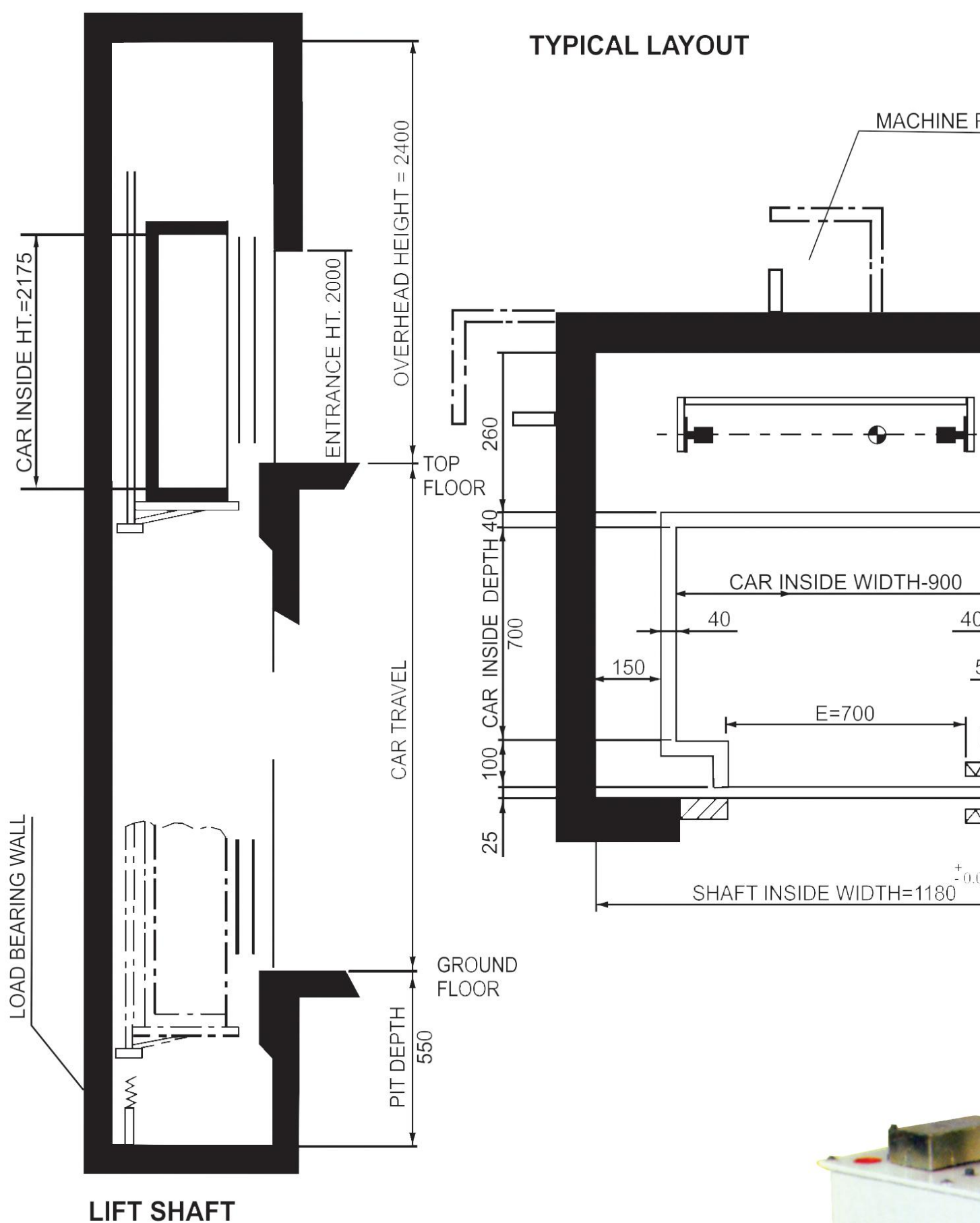

SPECIFICATIONS

Capacity : 3 Passengers (Max.204 Kgs.)

Cabin Weight : 230 Kgs. (Max.)

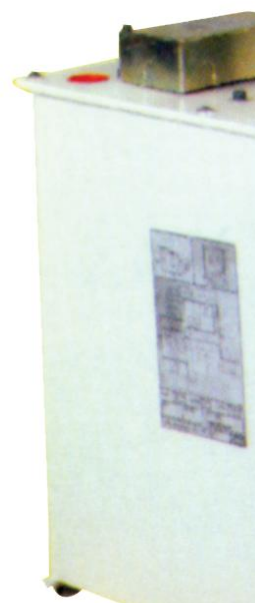

HYDRAULIC ELEVATOR

DIMENSIONAL REQUIREMENTS FOR 2:1 INDIRECT ACTING JACK

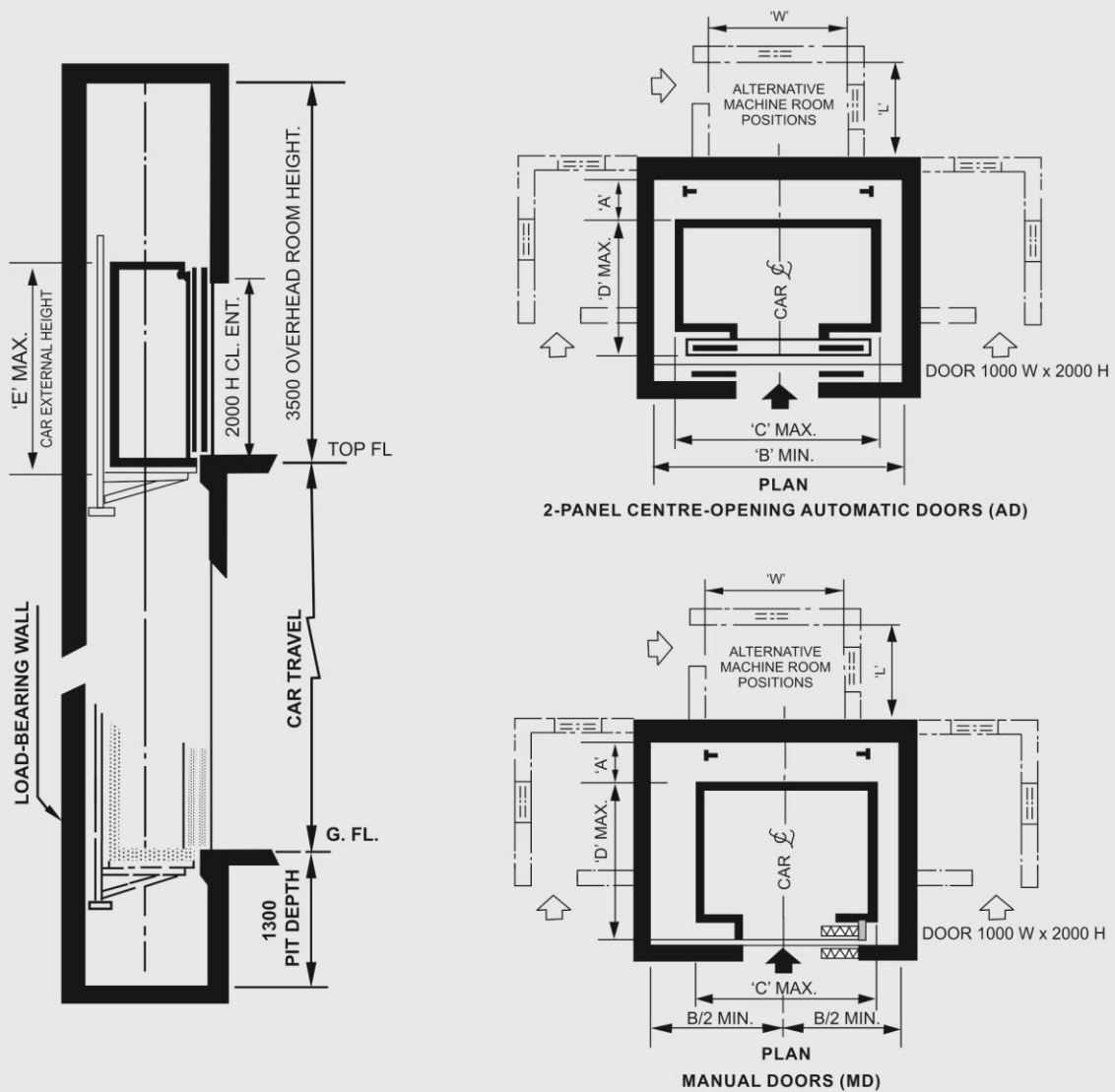

S. NO.	CAPACITY PERS.	KG.	CARFRAME TYPE	TYPE OF DOOR	'A' + 25 + 0	'B' MIN.	'C' MAX.	'D' MAX.	'E' MAX.	'W'	'L'
1	4	272	4080	MD	365	960	1200	1200	2380	2000	2000
			4080	AD	365	960	1200	1200			
2	5	340	4080	MD	365	960	1200	1200	2380	2000	2000
			4090	AD	365	1200	1360	1360			
3	6	408	4080	MD	365	960	1200	1200	2380	2000	2000
			4090	AD	365	1200	1360	1360			
4	8	544	4090	MD	365	1200	1360	1360	2380	2000	2000
			8650	AD	370	1200	1700	1465			
5	10	680	8650	MD	370	1200	1700	1465	2350	2000	2000
			8650	AD	370	1200	1700	1465			
6	13	884	8750	MD	445	1700	2660	1800	2350	2200	2200
			8750	AD	445	1700	2660	1800			
7	20	1360	1520	MD	490	2050	2400	2200	2450	2500	2500
			1520	AD	490	2050	2400	2200			
8	-	1000	8750	MD	445	1700	2660	1800	2350	2000	2000
			-	-	-	-	-	-			
9	-	2000	2020	MD	490	2050	2400	2200	2450	2000	2000
			-	-	-	-	-	-			

HYDRAULIC ELEVATOR

Hydraulic Car Elevator

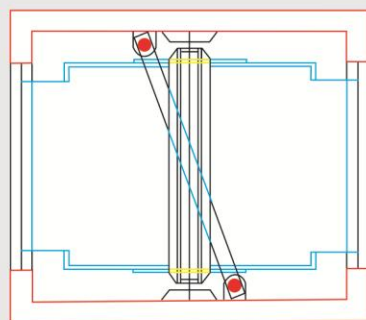
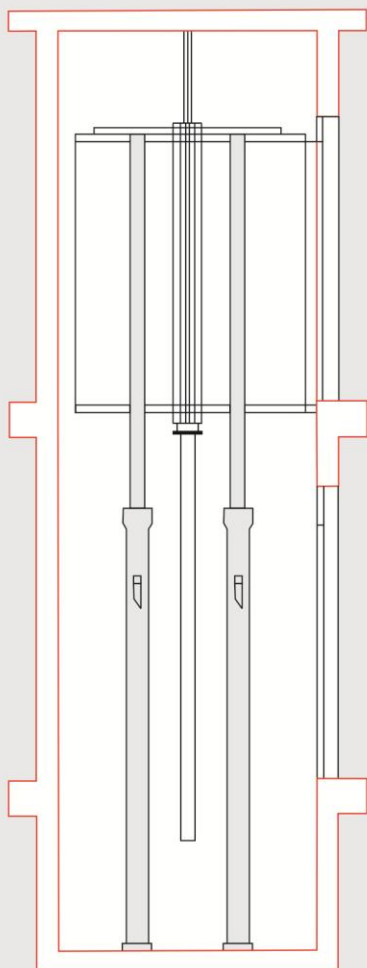

**DIRECT PISTONS
AT SIDE (2 NOS)**

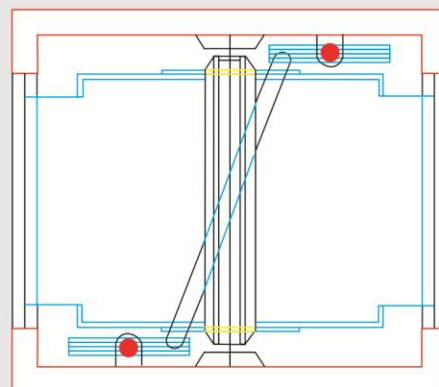
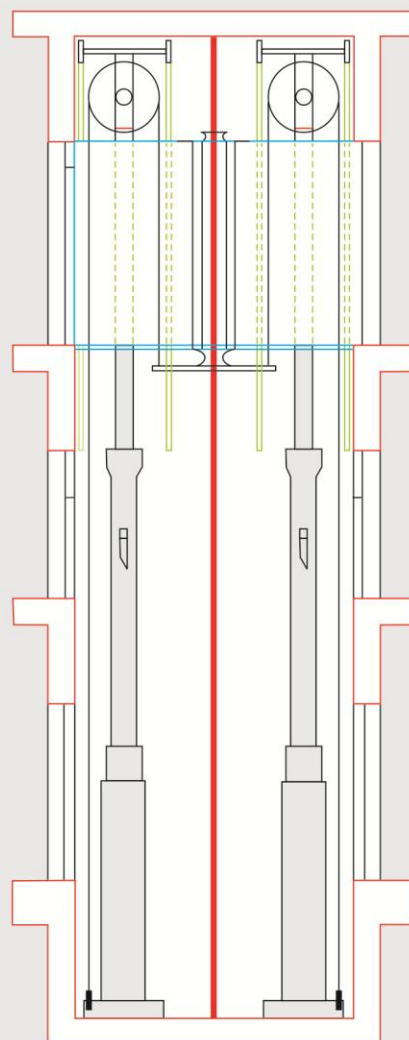

**INDIRECT PISTONS
AT SIDE (2 NOS)**

Hydraulic Car Elevator

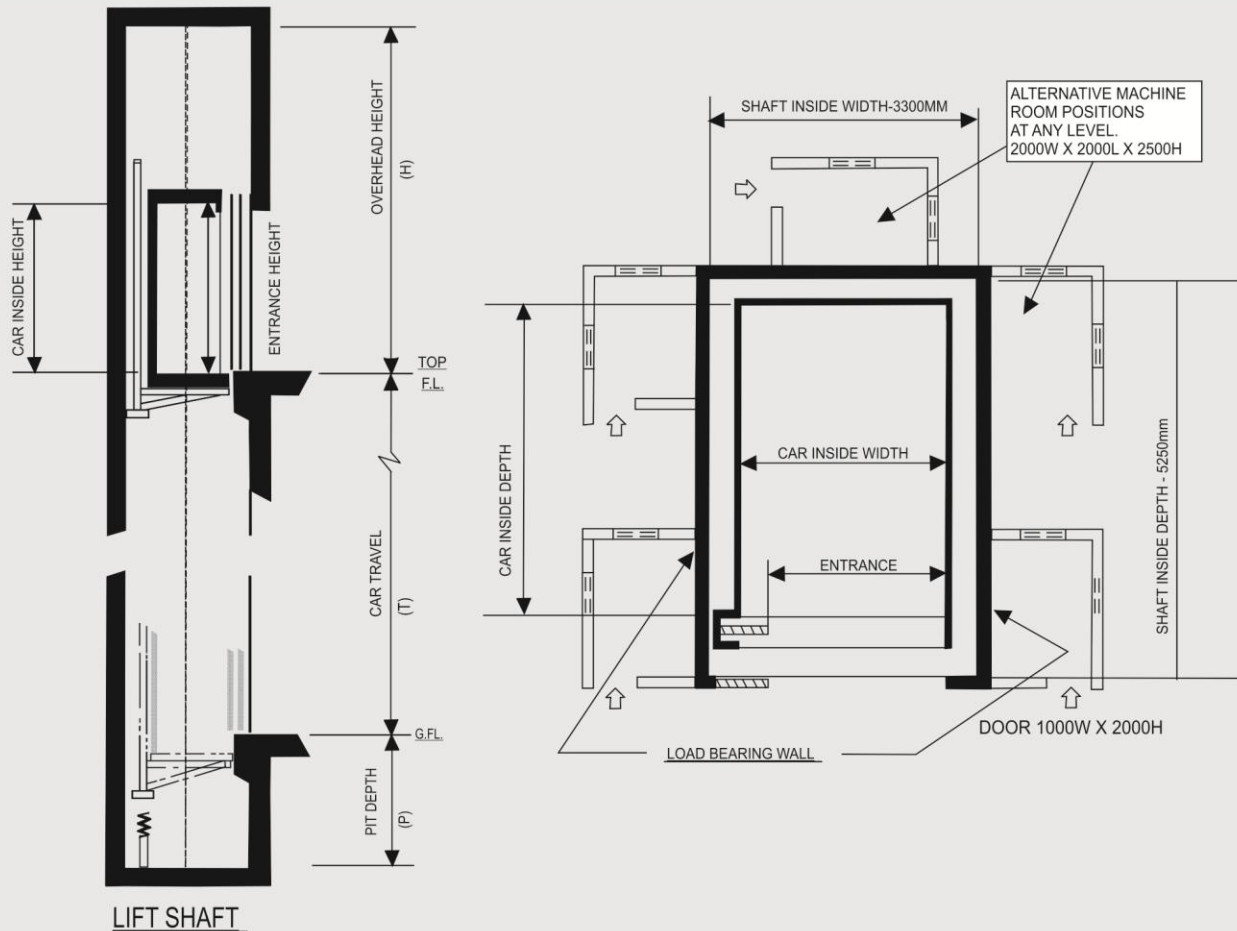

RECOMMENDED SHAFT DIMENSIONS FOR 2.5 TONNES HYDRAULIC CAR LIFT

TYPE OF LIFT	CAPACITY (KG.)	CAR+CAR FR. +ACC.WEIGHT (KG.)	TOTAL LOAD (MAX) (KG.)	CAR INSIDE DIMENSION (MM.)			ENTRANCE (MM.)		TRAVEL (MAX) (MM.)	PIT DEPTH (MIN) (MM.)	O.H. HEIGHT (MIN) (MM.)
				WIDTH	DEPTH	HEIGHT	WIDTH	HEIGHT			
DIRECT PISTONS AT SIDE (2 NOS.)	2500	2500	5000	2400	5000	2500	2300	2400	4000	1800	4000
INDIRECT PISTONS AT SIDE (2 NOS.)									10000	1500	3500
DIRECT TELESCOPIC PISTONS AT SIDE (NOS.)									12000	1800	4000
DIRECT PISTON BELOW (1NO.)									10000	1500	3500
DIRECT TELESCOPIC PISTON BELOW (1NO.)									20000	1500	3500

FEATURES :

- Suitable for small Plots having parking as constraint at Ground Level,
HIGHLY COST EFFECTIVE SOLUTION :
- Ramp not needed
- Ramp space can be utilised for additional parking.
- Building structure does not have to carry moving loads (Vehicle + Cabin)

MACHINE ROOM :

- Locational flexibility (any level)
- Very small machine room : 40 Sq. Ft.

A Comparison : Hydraulic v/s Traction Lifts

S.No.	DESCRIPTION	HYDRAULIC LIFT	TRACTION LIFT
ARCHITECTURAL	1.1 Location - Machine room	- Basement, ground or any convenient place e.g. under the strairs but within 20 mtrs. of lift shaft.	- Top of the building above the lift shaft.
	1.2 Size - Machine room	- Less than 5 sq. mtrs. (Abt 50 sq.ft.).	- About 16 sq. mtrs. (Abt 160 sq.ft.).
	1.3 Elevation	- No limitation.	- Limitation due to machine room at the top, or high cost to camouflage the machine room.
	1.4 Vertical load	- No vertical load on building structure. - Only one load bearing wall.	- Full vertical load due to machine room above lift shaft. - All walls.
	1.5 Old buildings	- When the building cannot take vertical load, often hydraulic lift is the only choice.	- Invariably independent structure required for installation.
	1.6 Lift shaft size	- 10% to 15% smaller than Traction lift due to no counter weight.	- 10% to 15% higher than hydraulic lift.
	1.7 Civil work Co-ordination	- Not required for machine room installation. - Required only for 2 guide rails. - Good possibility of compressing erection time.	- Required for machine room installation. - Required for 4 guide rails. - Less possibility of compressing erection time.
	1.8 Earthquake	- Safe as all loads at the bottom.	- Not safe as all loads at the top.
TECHNOLOGICAL	2.1 Power failure	- Lift comes down to nearest level with the help of a small battery. - It can be brought down to ground floor by pressing the button on the valve block. - In emergency, up travel possible with hand pump.	- Strenuous and cumbersome process to move the lift in any direction. - Alternatively, alternate power source required which is very expensive.
	2.2 Automatic doors	- Automatic doors possible with all speeds.	- Not recommended in single speed lifts.
	2.3 Freight lift	- Ideal for low and medium rise buildings Hydraulic principle provides greater lifting force due to higher mechanical efficiency.	- No such advantage.
	2.4 Travel	- Available up to 23 mtrs. in India.	- No limitation.
	2.5 Speed	- Available up to 1 mtr/sec. in India.	- Much higher speeds are available.
	2.6 Maintenance	- Quick & Simple.	- Moderate.
ARCHITECTURAL	3.1 Riding comfort	- Smooth ride, Inherent property of Hydraulic transmission.	- Not so smooth. In case of single and two speed lifts.
	3.2 Levelling	- Levelling accuracy +10 mm.	- Inaccurate levelling in single and two speed due to variation in brake slip.
	3.3 Noise level	- Silent due to specially designed motor & pump immersed in oil.	- High due to machine and chattering of contactors.
	3.4 Vibration	- Almost pulsation free pumping.	- Machine vibrations transmitted through columns & beams.
	3.5 Breakdown frequency	- Low.	- Moderate.
COST	4.1 Rower cable	- Shorter cable as machine room located on lower level.	- Longer cable as machine room located on top floor.
	4.2 Civil work	- Saving due to point No 1.1. 1 2 & 1.4 above.	- Not applicable.
	4.3 Saleable area	- Additional area available due to smaller lift shaft.	- No additional saleable area available.

CLIENTELE / PROJECTS



GURUDWARA IMLISAHEB - INDORE



KAKA HALWAI - PUNE



HOTEL PRIDE - PUNE



SURAT MERCANTILE BANK - SURAT



SHIVSHAKTI CENTRE - SURAT

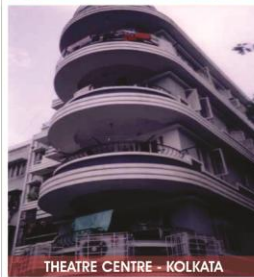

THEATRE CENTRE - KOLKATA

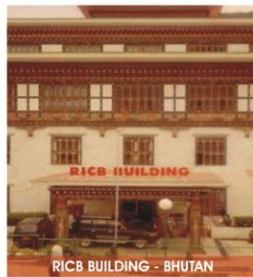

RICB BUILDING - BHUTAN

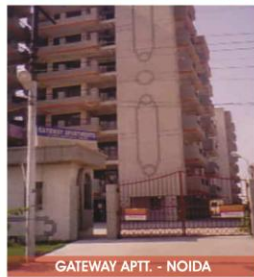

GATEWAY APTT. - NOIDA

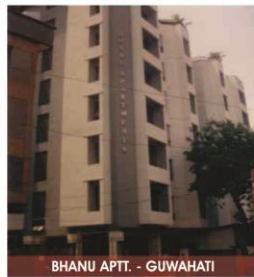

BHANU APTT. - GUWAHATI

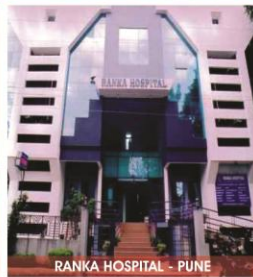

RANKA HOSPITAL - PUNE

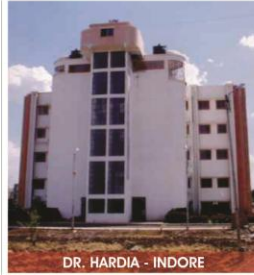

DR. HARDIA - INDORE

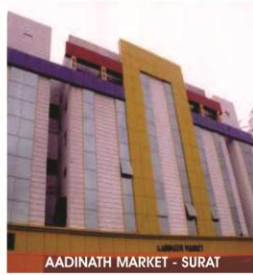

AADINATH MARKET - SURAT

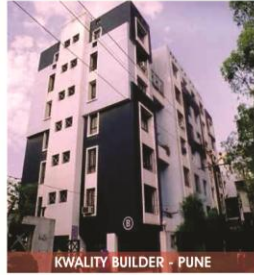

KWALITI BUILDER - PUNE

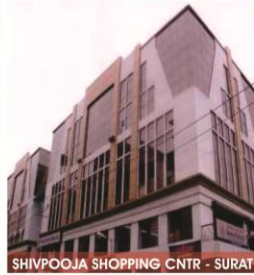

SHIVPOOJA SHOPPING CNTR - SURAT

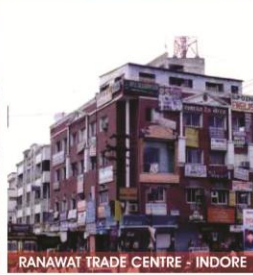

RANAWAT TRADE CENTRE - INDORE



SWAMINARAYAN COMPLEX - SURAT

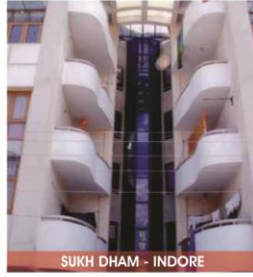

SUKH DHAM - INDORE

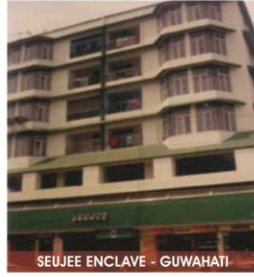

SEJJE ENCLAVE - GUWAHATI



HOTEL SURYA KIRAN - PUNE

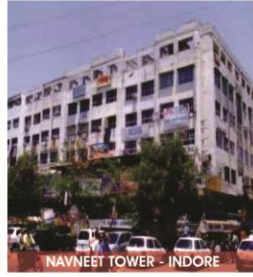

NAVNEET TOWER - INDORE

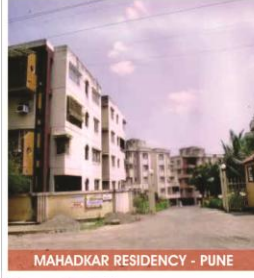

MAHADKAR RESIDENCY - PUNE

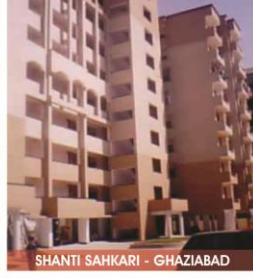

SHANTI SAHKARI - GHAZIABAD



SHYAM SANGAM HOUSE - INDORE

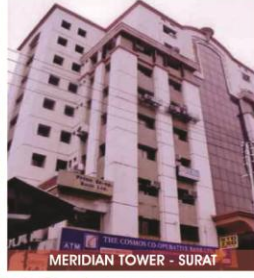

MERIDIAN TOWER - SURAT

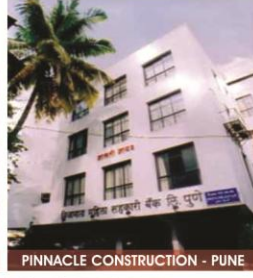

PINNACLE CONSTRUCTION - PUNE

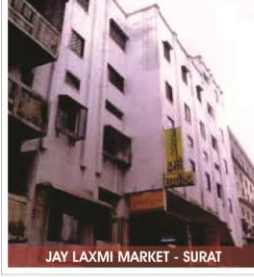

JAY LAXMI MARKET - SURAT

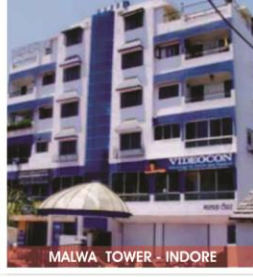

MALWA TOWER - INDORE



NEW CRPF CHGS - GURGAON

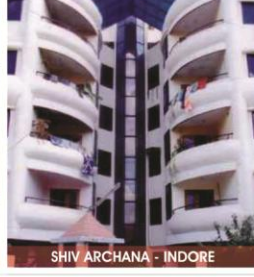

SHIV ARCHANA - INDORE

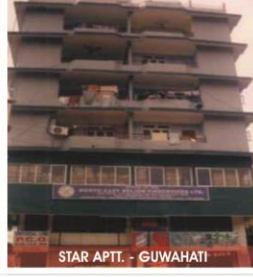

STAR APTT. - GUWAHATI

KINETIC

Lift for Life Time

ROYAL HIGHNESS OF BHUTAN, ATUL LTD., **ANSAL HOUSING**, SAI DEVELOPERS-PUNE, CIRCUIT HOUSE-SURAT, NPCC-NEWDELHI, PLETHICO PHARMA LTD.-INDORE, OMKISHAN HOSPITAL-JODHPUR, S.R.FOOD PRODUCT-INDORE, **MUMBAI PORT TRUST-MUMBAI**, CHHAGANLAL M.KUMAR-ASANSOL, **NBCC-NEWDELHI**, G. S. F. C. LTD.-KOSAMBA, ALKEM PHARMACEUTICALS LTD.-DAMAN, SATYAM BUILDERS-GWALIOR, **PARAM INDUSTRIES LTD.-GANDHIDHAM**, XPRO INDIA LIMITED-MUMBAI, SHIV-SHAKTI TEXTILE MARKET-SURAT, **VIDEOCON INDUSTRIES LTD.**, SURYA CONSTRUCTION-PATNA, T.T.TEXTILE MARKET-SURAT, **HINDUSTAN AERONOTICS LTD.-LUCKNOW**, SHREE MODHPATNI SAMAJ TRUST-SURAT, SAMARPAN HOSPITAL-RATLAM, **COFMOW-NEWDELHI**, MAHADKAR CONSTRUCTION-PUNE, P.V.N.FABRICS-DAMAN, **AMC-AHMEDABAD**, **STEEL AUTHORITY OF INDIA**, B. K. ESTATE-NASHIK, JAGATGURU SHANKRACHARYA ASHRAM, **DEPARTMENT OF POST**, GAIKWAD DEVELOPERS-PUNE, BALAJI CONSTRUCTION-PUNE, RATHI CONSTRUCTION-AURGANBAD, **METROPOLIS DEVELOPERS-SURAT**, ESSEN CONSTRUCTION-BHUBNESHWAR, SIDDHI VINAYAK CONSTRUCTION PVT. LTD.-PUNE, S. L. ASSOCIATES-GREATER NOIDA, KAKA HALWAI-PUNE, AAKARTI CONSTRUCTION-GUWAHATI, **TRAUMA CENTRE-SURAT**, TENAMENTS-GUWAHATI, MODEL REAL ESTATE-GOA, MEGH MALHAR ESTATE & SERVICES (P) LTD.-GUWAHATI, AMBE BHARATI PATRAKAR SAMITI-G NOIDA, M.P. STATE ASSEMBLY-BHOPAL, BAJAJ ELECTRICALS, INDECHMIE PVT.LTD.-DAMAN, SURYA OFFSET PVT. LTD.-AHMEDABAD, KOHINOOR ASSOCIATES-PUNE, **SUMUL DAIRY-SURAT**, **GUJARAT BHAVAN-NEW DELHI**, MANJUSHREE CONSTRUCTION-GUWAHATI, UNICHEM LABORATORIES LTD.-PITHAMPUR, GHARI INDUSTRIES PVT. LTD.-KANPUR, ASIAN STAR CO. LTD.-MUMBAI, **ADANI AGRI LOGISTICS LIMITED**, GIRIRAJ DEVELOPERS-PUNE, DURGA DEVELOPERS-PATNA, SANGAM TECHNO CRAFT-GREATER NOIDA, **DR. KAMBLE HOSPITAL-PUNE**, GATEWAY AWAS SAMITI-NOIDA, RANKA HOSPITAL-PUNE, BHIM POLY FAB-DAMAN, **ROAD & BUILDING DEPARTMENT-GUJARAT**, SURANA HOSPITAL-PALI, **SAHI BUILDERS-MOHALI**, DELHI UNIEVRSITY, BURNWELL BUILDERS & DEVELOPERS-PATIALA, SURAT OFFICERS GYMKHANA-SURAT, CHITRANGNA APPT.-ANAND, **AHMEDNAGAR SAHAR SEHKARI BANK-AURANGABAD**, JAIN NURSING HOME-INDORE, AGRAGAMI CONSTRUCTION, TAPTI HEALTHCARE -BURHANPUR, DISTRICT ENGINEER-HUGLI, **BAGRECHA ENTERPRISE-COIMBATORE**, **NEW CRPF CGHS LTD.-GURGAON**, DR. JJ SIDDHPURA-BHAVNAGAR, MOKHA CONSTRUCTION-JABALPUR, LOKSEWA HOTEL-AHMEDNAGAR, SHANTI SEHKARI CGHS LTD.-NOIDA, MSEB-PUNE, M.P. SHAH MEDICAL COLLEGE, JAMNAGAR, JAMNAGAR AREA DEVELOPMENT AUTHORITY, VIMAL CONSTRUCTION-RAIPUR, **NEPAL POLICE HOSPITAL-KATHMANDU**, DRM OFFICE-AHMEDABAD, DR. WAGH HOSPITAL-AHMEDNAGAR, M. B. INSTITUTE-KOLKATA, HOPE NURSING HOME-BURDWAN, **BENFISH - KOLKATA**, NAVSARI AGRICULTURAL UNIVERSITY, NAVSARI AGRI-BUSINESS MANAGEMENT, SHREE LABH ARCHITECTS-SURAT, SALASAR CORPORATION-SURAT, REAL FORCE-PUNE, DR. JAWAHAR JETHWA-AHMEDABAD, UDHNA HOSPITAL-SURAT, **PRERNA HOSPITAL-KOLHAPUR**, CAPITAL HOSPITAL-KATHMANDU, VISHWARETA DEVELOPERS-ASANSOL, KDM HOSPITAL-PUNE, ROYAL CONSTRUCTION-BHARUCH, **NEW TT MARKET-SURAT**, CENTRAL WARE HOUSING CORPORATION, H.P. UNIVERSITY, KISAN BUILDERS-INDORE, TULSI DEVELOPERS-ANKLISHWAR, **BANK NOTE PRESS-DEWAS**, PAWANI BUILDWELL-PATIALA, KASTURI DEVELOPERS, LATUR, HOTEL SWATIK-AHMEDNAGAR, APSARA MINIMALL-GWALIOR, BHAGAT AEROMATIC LTD.-NOIDA, MODERN CONSTRUCTION-AHMEDNAGAR, **RUCHI SOYA INDUSTRIES LTD.-CHENNAI**, KEWALYA CONSTRUCTION-GWALIOR, INDIAN RAILWAYS, SAHARA CONSTRUCTION-JAMSHEDPUR, HOTEL ROYAL RESIDENCY-TEJPUR, SWARNAKALA CONSTRUCTION-KANPUR, **SHUBHAM CONSTRUCTION-MIDNAPUR**, DHARAM CGHS LTD.-DWARKA-NEWDELHI, AGARWAL INSTITUTE OF MEDICAL SCIENCE-RAIPUR, DR. Y R KRISHNA HOSPITAL-BILASPUR, HOTEL GUJARAT PALACE-UJJAIN, SARASWATI DEVELOPERS-NANDED, M. M. CONSTRUCTION-COIMBATORE, **UNITED CGHS LTD.-MOHALI**, CPWD-UDAIPUR, BALAJI CONSTRUCTION-JAMSHEDPUR, ROYAL ESTATE-AKOLA, ANANT CONSTRUCTION-VALSAD, RAJIV PLAZA-BILASPUR, CHAUHAN ESTATE-BHILAI, HOTEL TATHAGAT-BODHGAYA, **DINDAYAL UPADHYAY VANIJYA BHAVAN-ANAND**, PATIL EYE HOSPITAL-NASIK, MAA CONSTRUCTION-PATNA, **BOMBAY HOSPITAL & RESEARCH CENTRE-JABALPUR**, PINNACLE CONSTRUCTION-PUNE, AMBE BHARTI PATRAKAR SAMITI-GHAZIABAD, DILIP RAO & SONS-NASHIK, VINIT CONSTRUCTION-INDORE, BSNL, KISHAN CONSTRUCTION-BHUBNESHWAR, **MOTHERSONS-BANGLORE**

.....& More than 7000 Esteemed Projects !!!

KINETWORK



KINETIC

Lift for life time

ISO 9001:2008

KINETIC ELEVATORS LIMITED

Corporate Office : 73, City Centre, Swastic Cross Road, C.G.Road, Navrangpura, Ahmedabad-380 009. Gujarat. INDIA.

T : 0091 79 26400975-26400978 F : 0091 79 26401173

E : sales@kineticelevators.com

W : www.kineticelevators.com

THE PHOTOGRAPHS AND DRAWINGS ARE GENERAL ILLUSTRATION OF OUR PRODUCTS.
WE RESERVE THE RIGHT TO ALTER SOME OF SPECIFICATIONS AND DESCRIPTIONS GIVEN HEREIN WITHOUT PRIOR NOTICE.